

# THE RANGES

GLEDSDWOOD HILLS

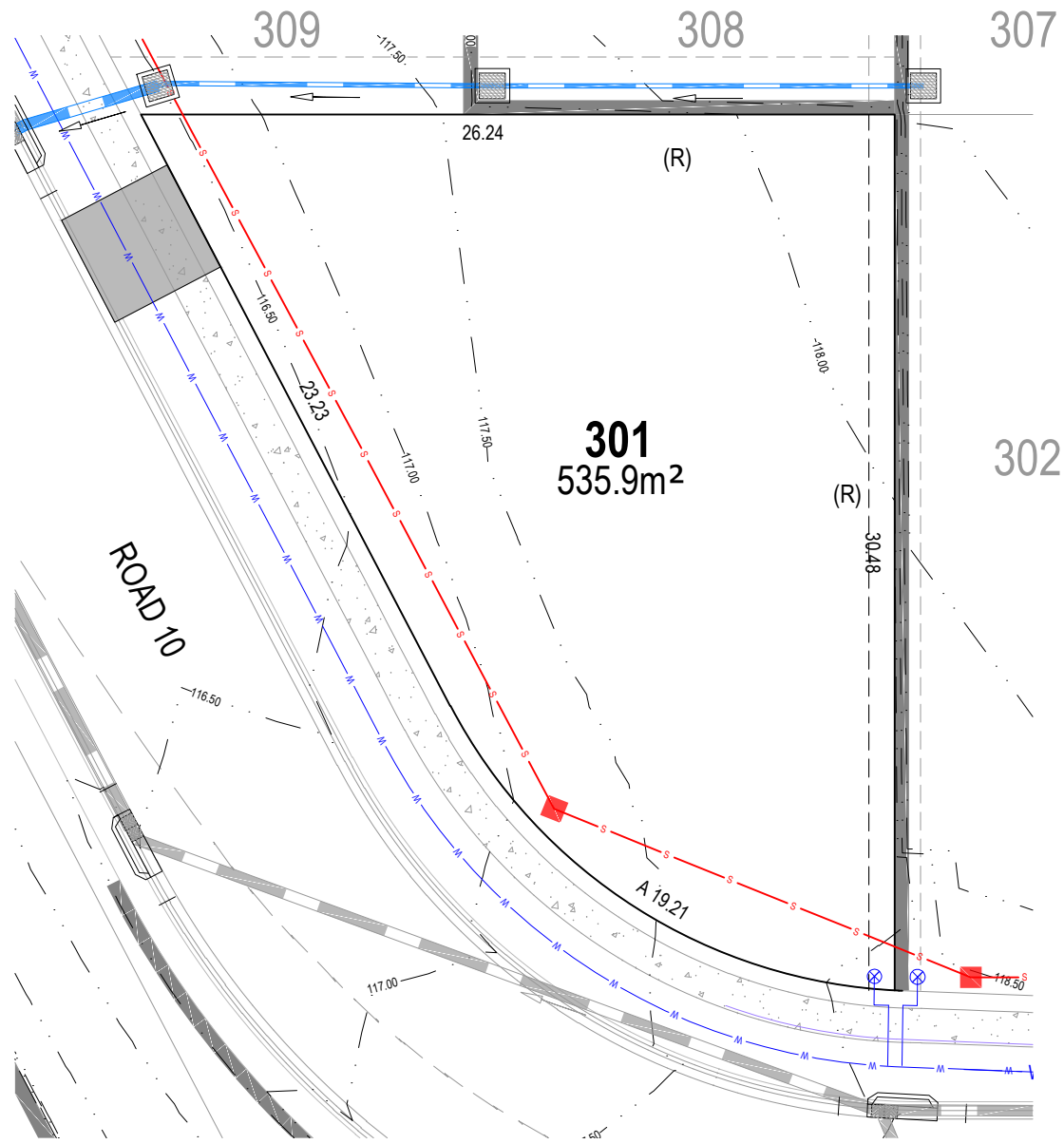

## LEGEND

- |     |                              |     |   |
|-----|------------------------------|-----|---|
| 101 | PROPOSED CONTOUR             | (A) | EASEMENT FOR DRAINAGE (2.00m WIDE)                          |
|     | PROPOSED RETAINING WALL      | (R) | RETAINING WALL RESTRICTION & POSITIVE COVENANT (0.90m WIDE) |
|     | PROPOSED WATER               |     |   |
|     | PROPOSED SEWER               |     |   |
|     | PROPOSED STORMWATER AND PITS |     |   |
|     | PROPOSED EASEMENTS           |     |   |



• AREA SUBJECT TO FINAL SURVEY  
 • BEARING AND DISTANCES SUBJECT TO FINAL SURVEY

0 5 10 A4  
 1:250

NOTE:  
 ALL CONTOURS HAVE INTERVAL OF 0.5m (CONTOURS ARE APPROXIMATE ONLY)

This plan is provided solely for the purpose of providing an impression of the concept relating to the proposed development called 'The Ranges', as well as the approximate location of existing and proposed third party facilities, services or destinations, and is not intended to be used for any other purpose. Legacy Property does not make any representation or give any warranty in relation to the future development of the site, the staging of any future development or the current or future location or existence of any facilities, services or destinations. The plan is based on the present intention of, and information available to, Legacy Property and the current known requirements of relevant authorities at the time of creation of the plan and details may change due to future circumstances. Any indications of distance or size are approximate and for indicative purposes only and are not to scale. The plan and any matters shown on or inferred from it do not give rise to a legally binding obligation on or representation or warranty by Legacy Property. Legacy Property accepts no liability for any loss or damage arising as a result of any reliance on this plan or its contents.



# THE RANGES

GLEDSDOOD HILLS

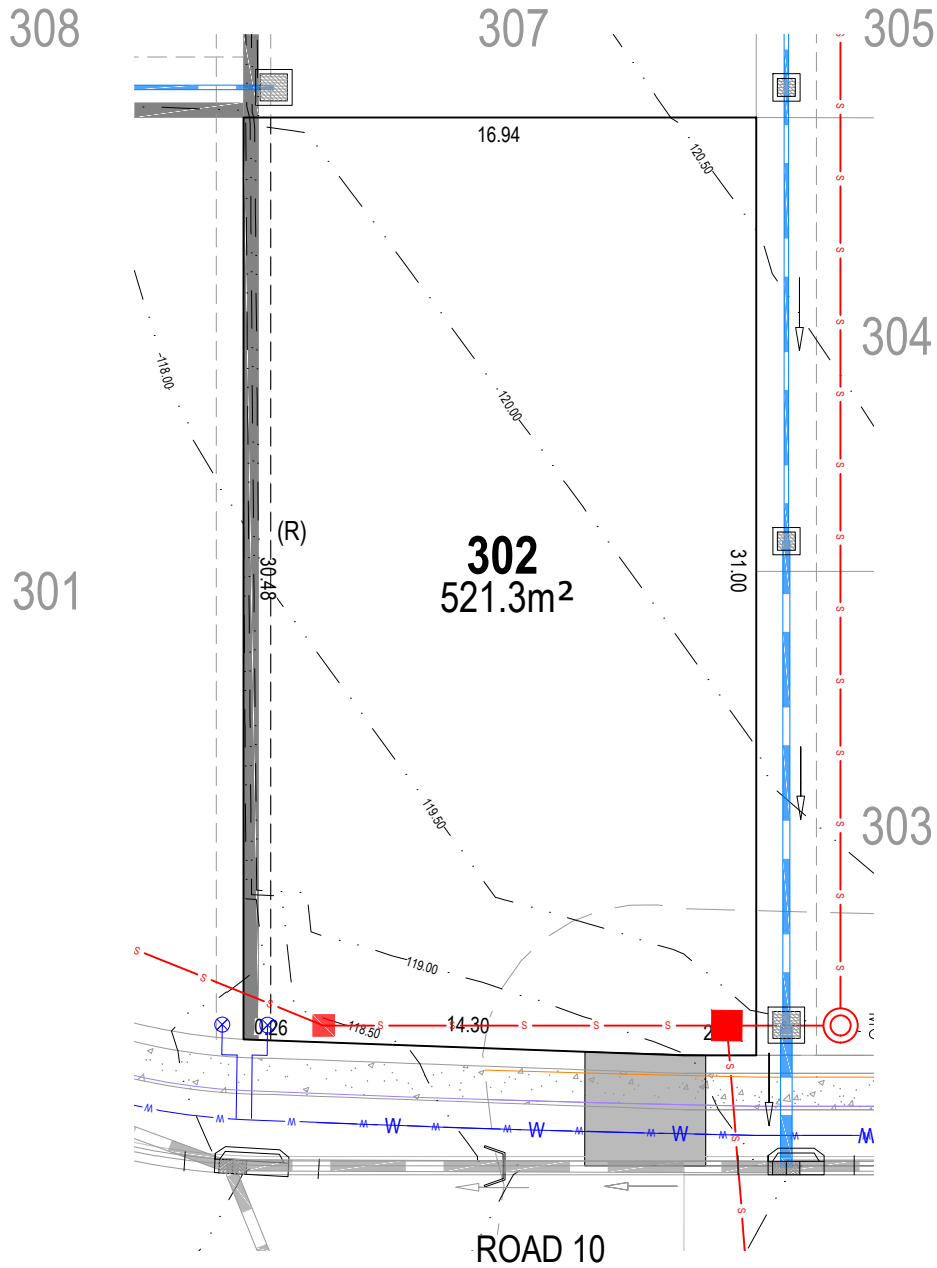

## LEGEND

- |  |                              |     |   |
|--|------------------------------|-----|---|
|  | 101 PROPOSED CONTOUR         | (A) | EASEMENT FOR DRAINAGE (2.00m WIDE)                          |
|  | PROPOSED RETAINING WALL      | (R) | RETAINING WALL RESTRICTION & POSITIVE COVENANT (0.90m WIDE) |
|  | PROPOSED WATER               |     |   |
|  | PROPOSED SEWER               |     |   |
|  | PROPOSED STORMWATER AND PITS |     |   |
|  | PROPOSED EASEMENTS           |     |   |



• AREA SUBJECT TO FINAL SURVEY  
 • BEARING AND DISTANCES SUBJECT TO FINAL SURVEY

0 5 10 A4  
 1:250

NOTE:  
 ALL CONTOURS HAVE INTERVAL OF 0.5m (CONTOURS ARE APPROXIMATE ONLY)

This plan is provided solely for the purpose of providing an impression of the concept relating to the proposed development called 'The Ranges', as well as the approximate location of existing and proposed third party facilities, services or destinations, and is not intended to be used for any other purpose. Legacy Property does not make any representation or give any warranty in relation to the future development of the site, the staging of any future development or the current or future location or existence of any facilities, services or destinations. The plan is based on the present intention of, and information available to, Legacy Property and the current known requirements of relevant authorities at the time of creation of the plan and details may change due to future circumstances. Any indications of distance or size are approximate and for indicative purposes only and are not to scale. The plan and any matters shown on or inferred from it do not give rise to a legally binding obligation on or representation or warranty by Legacy Property. Legacy Property accepts no liability for any loss or damage arising as a result of any reliance on this plan or its contents.

1800 083 990

therangesestate.com.au



LEGACYPROPERTY

# THE RANGES

GLEDSDOOD HILLS

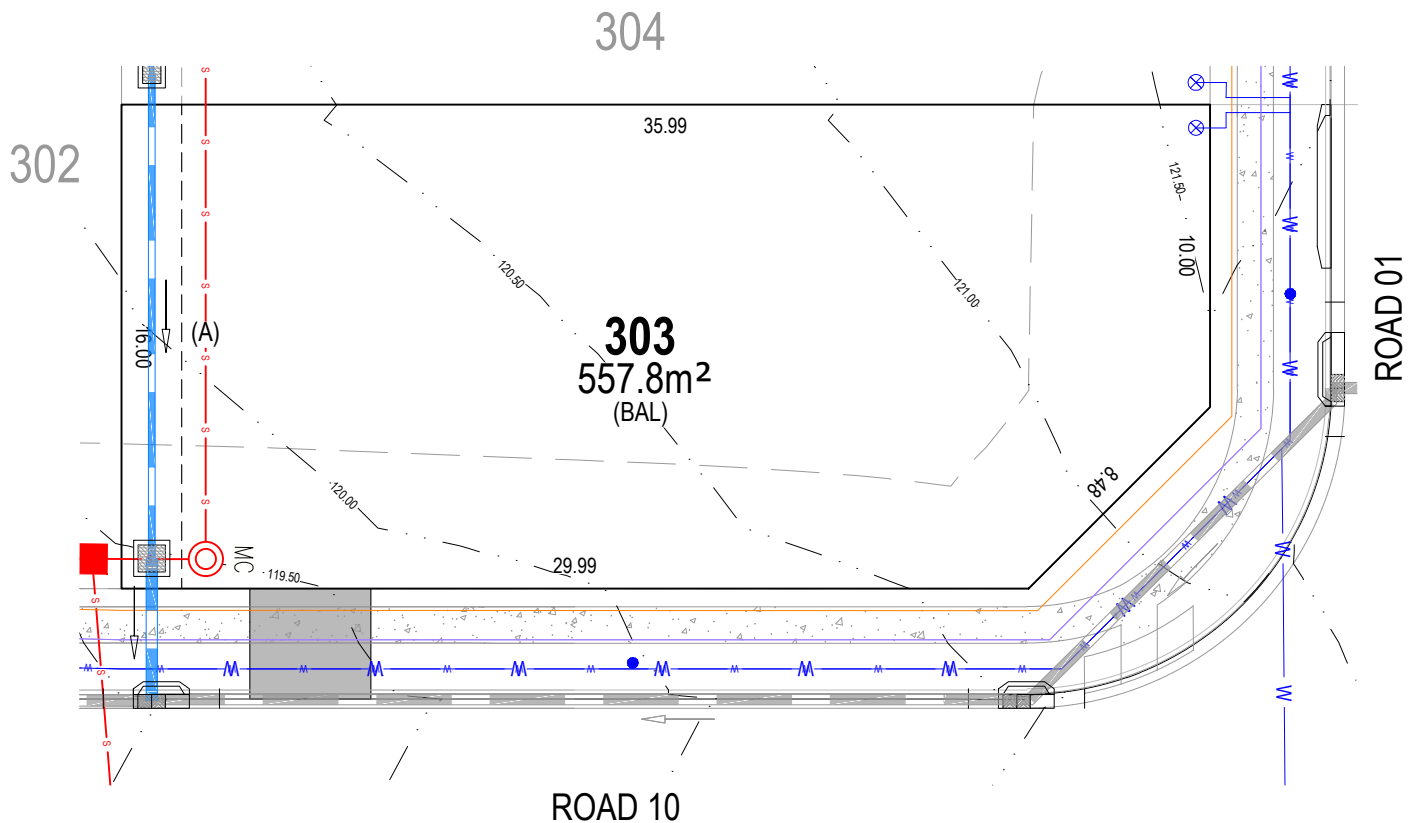

## LEGEND

|     |                              |       |   |
|-----|------------------------------|-------|---|
| 101 | PROPOSED CONTOUR             | (A)   | EASEMENT FOR DRAINAGE (2.00m WIDE)                          |
|     | PROPOSED RETAINING WALL      | (R)   | RETAINING WALL RESTRICTION & POSITIVE COVENANT (0.90m WIDE) |
|     | PROPOSED WATER               | (BAL) | BUSHFIRE ATTACK LEVEL - 12.5                                |
|     | PROPOSED SEWER               |       |   |
|     | PROPOSED STORMWATER AND PITS |       |   |
|     | PROPOSED EASEMENTS           |       |   |



• AREA SUBJECT TO FINAL SURVEY  
 • BEARING AND DISTANCES SUBJECT TO FINAL SURVEY

0 5 10 A4  
 1:250

NOTE:  
 ALL CONTOURS HAVE INTERVAL OF 0.5m (CONTOURS ARE APPROXIMATE ONLY)

This plan is provided solely for the purpose of providing an impression of the concept relating to the proposed development called 'The Ranges', as well as the approximate location of existing and proposed third party facilities, services or destinations, and is not intended to be used for any other purpose. Legacy Property does not make any representation or give any warranty in relation to the future development of the site, the staging of any future development or the current or future location or existence of any facilities, services or destinations. The plan is based on the present intention of, and information available to, Legacy Property and the current known requirements of relevant authorities at the time of creation of the plan and details may change due to future circumstances. Any indications of distance or size are approximate and for indicative purposes only and are not to scale. The plan and any matters shown on or inferred from it do not give rise to a legally binding obligation on or representation or warranty by Legacy Property. Legacy Property accepts no liability for any loss or damage arising as a result of any reliance on this plan or its contents.



# THE RANGES

GLEDSDOOD HILLS

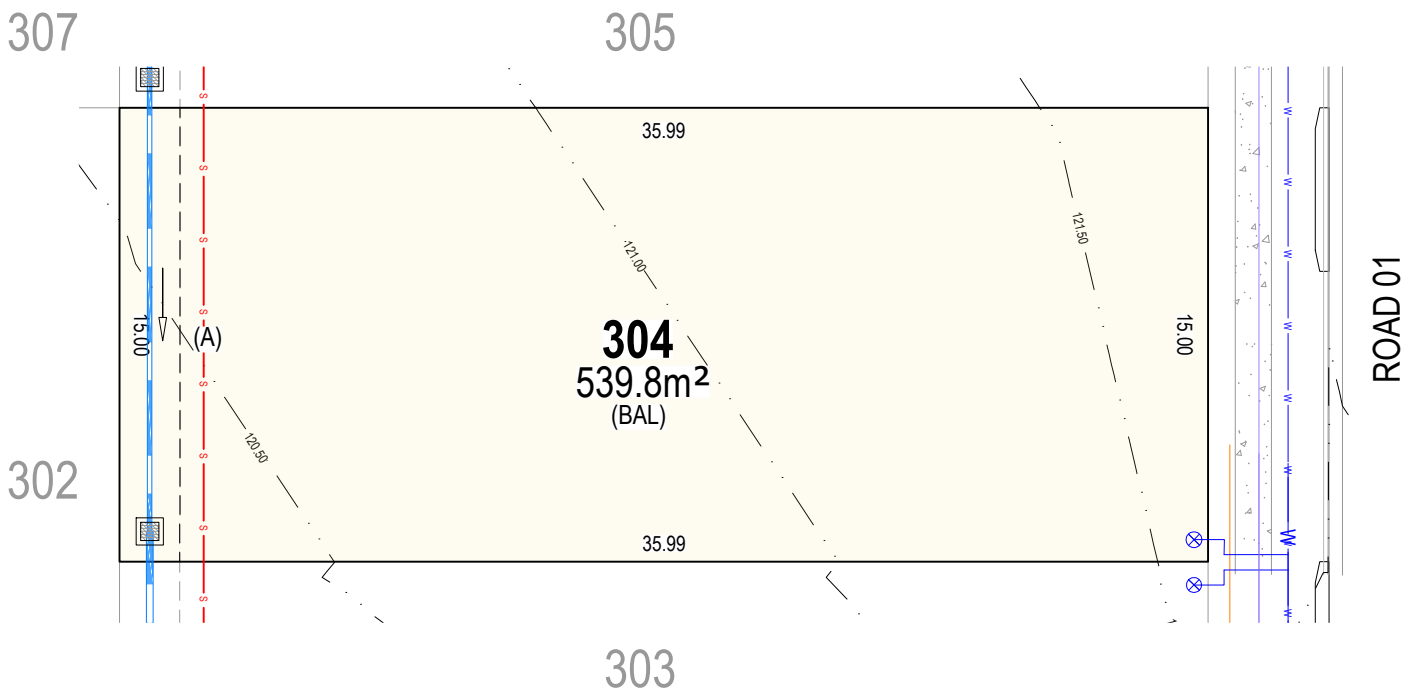

## LEGEND

|  |                              |       |   |
|--|------------------------------|-------|---|
|  | 101 PROPOSED CONTOUR         | (A)   | EASEMENT FOR DRAINAGE (2.00m WIDE)                          |
|  | PROPOSED RETAINING WALL      | (R)   | RETAINING WALL RESTRICTION & POSITIVE COVENANT (0.90m WIDE) |
|  | PROPOSED WATER               | (BAL) | BUSHFIRE ATTACK LEVEL - 12.5                                |
|  | PROPOSED SEWER               |       |   |
|  | PROPOSED STORMWATER AND PITS |       |   |
|  | PROPOSED EASEMENTS           |       |   |



• AREA SUBJECT TO FINAL SURVEY  
 • BEARING AND DISTANCES SUBJECT TO FINAL SURVEY

0 5 10 A4  
 1:250

NOTE:  
 ALL CONTOURS HAVE INTERVAL OF 0.5m (CONTOURS ARE APPROXIMATE ONLY)

This plan is provided solely for the purpose of providing an impression of the concept relating to the proposed development called 'The Ranges', as well as the approximate location of existing and proposed third party facilities, services or destinations, and is not intended to be used for any other purpose. Legacy Property does not make any representation or give any warranty in relation to the future development of the site, the staging of any future development or the current or future location or existence of any facilities, services or destinations. The plan is based on the present intention of, and information available to, Legacy Property and the current known requirements of relevant authorities at the time of creation of the plan and details may change due to future circumstances. Any indications of distance or size are approximate and for indicative purposes only and are not to scale. The plan and any matters shown on or inferred from it do not give rise to a legally binding obligation on or representation or warranty by Legacy Property. Legacy Property accepts no liability for any loss or damage arising as a result of any reliance on this plan or its contents.



# THE RANGES

GLEDSDOOD HILLS

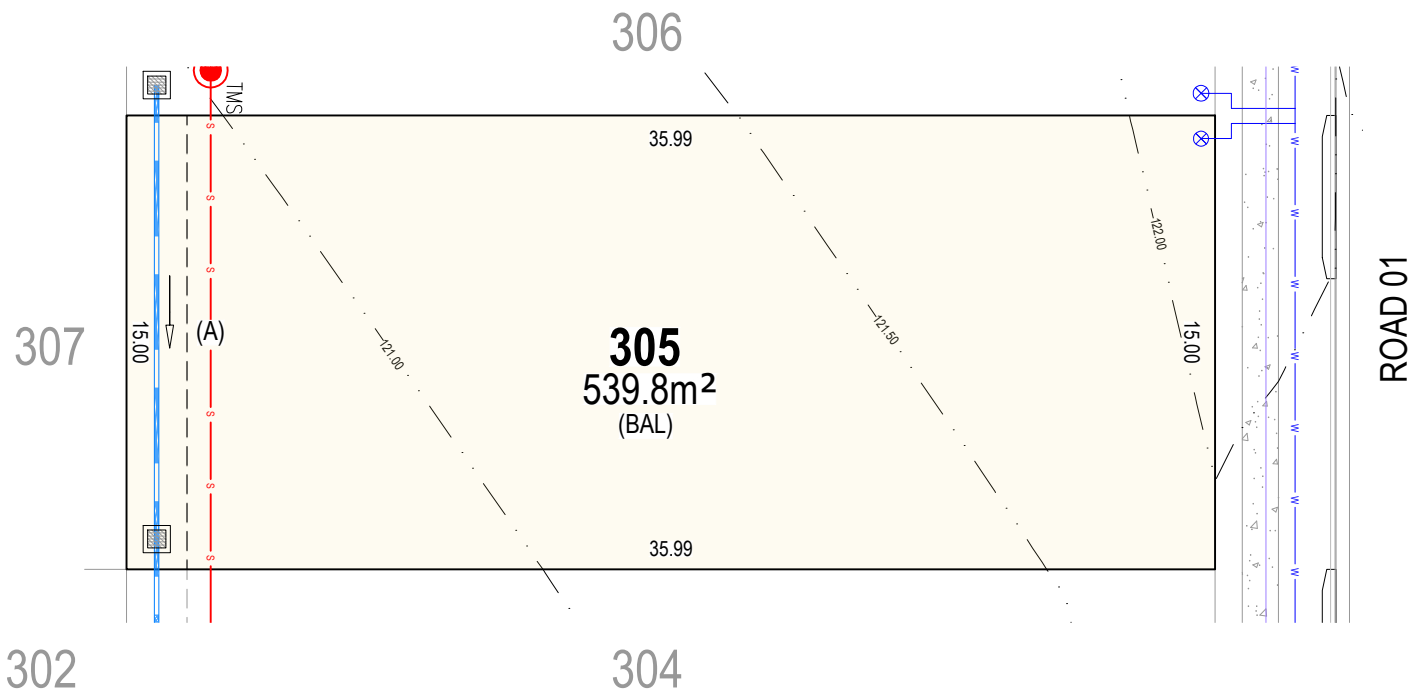

## LEGEND

|     |                              |       |   |
|-----|------------------------------|-------|---|
| 101 | PROPOSED CONTOUR             | (A)   | EASEMENT FOR DRAINAGE (2.00m WIDE)                          |
|     | PROPOSED RETAINING WALL      | (R)   | RETAINING WALL RESTRICTION & POSITIVE COVENANT (0.90m WIDE) |
|     | PROPOSED WATER               | (BAL) | BUSHFIRE ATTACK LEVEL - 12.5                                |
|     | PROPOSED SEWER               |       |   |
|     | PROPOSED STORMWATER AND PITS |       |   |
|     | PROPOSED EASEMENTS           |       |   |



• AREA SUBJECT TO FINAL SURVEY  
• BEARING AND DISTANCES SUBJECT TO FINAL SURVEY

0 5 10 A4  
1:250

NOTE:  
ALL CONTOURS HAVE INTERVAL OF 0.5m (CONTOURS ARE APPROXIMATE ONLY)

This plan is provided solely for the purpose of providing an impression of the concept relating to the proposed development called 'The Ranges', as well as the approximate location of existing and proposed third party facilities, services or destinations, and is not intended to be used for any other purpose. Legacy Property does not make any representation or give any warranty in relation to the future development of the site, the staging of any future development or the current or future location or existence of any facilities, services or destinations. The plan is based on the present intention of, and information available to, Legacy Property and the current known requirements of relevant authorities at the time of creation of the plan and details may change due to future circumstances. Any indications of distance or size are approximate and for indicative purposes only and are not to scale. The plan and any matters shown on or inferred from it do not give rise to a legally binding obligation on or representation or warranty by Legacy Property. Legacy Property accepts no liability for any loss or damage arising as a result of any reliance on this plan or its contents.



# THE RANGES

GLEDSWOOD HILLS

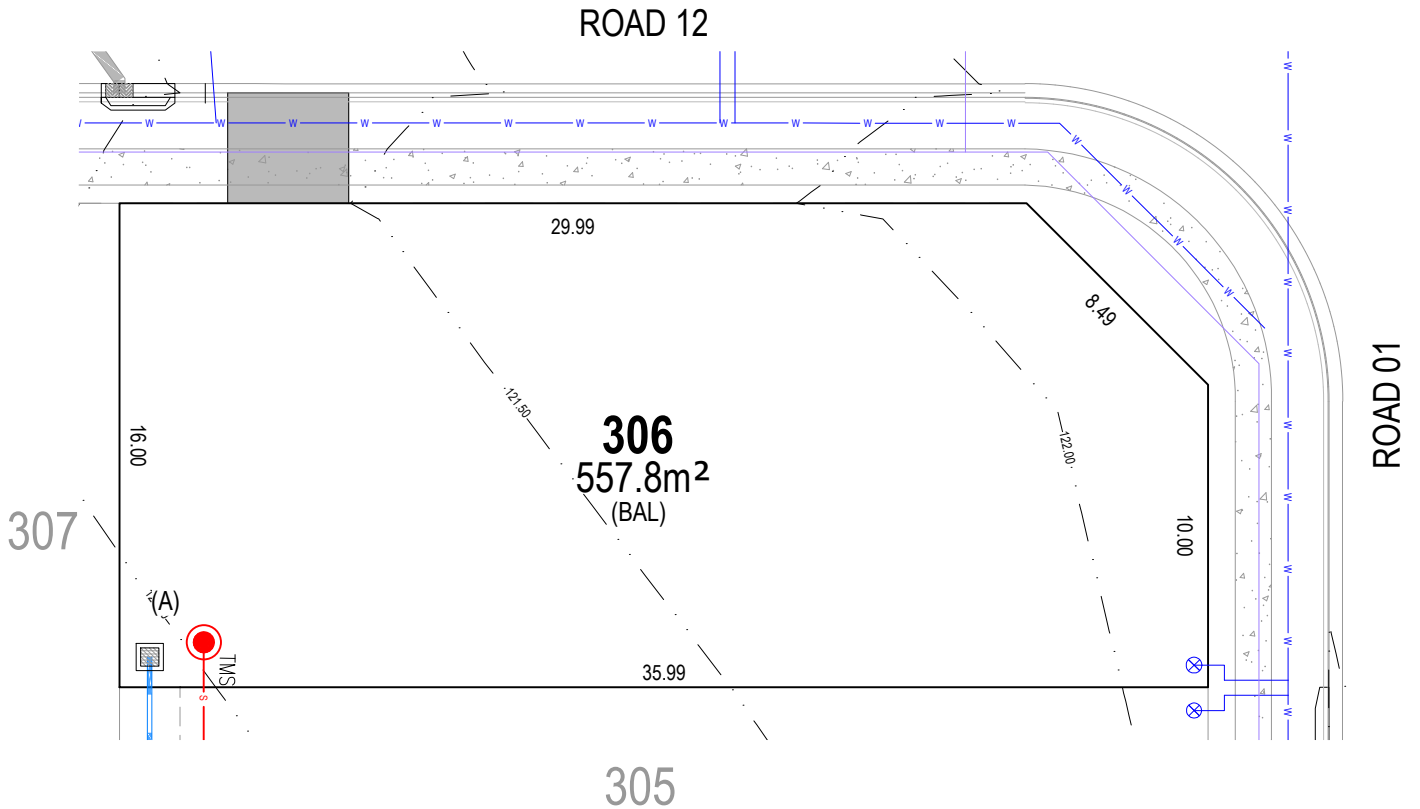

## LEGEND

|     |                              |       |   |
|-----|------------------------------|-------|---|
| 101 | PROPOSED CONTOUR             | (A)   | EASEMENT FOR DRAINAGE (2.00m WIDE)                          |
|     | PROPOSED RETAINING WALL      | (R)   | RETAINING WALL RESTRICTION & POSITIVE COVENANT (0.90m WIDE) |
|     | PROPOSED WATER               | (BAL) | BUSHFIRE ATTACK LEVEL - 12.5                                |
|     | PROPOSED SEWER               |       |   |
|     | PROPOSED STORMWATER AND PITS |       |   |
|     | PROPOSED EASEMENTS           |       |   |



• AREA SUBJECT TO FINAL SURVEY  
 • BEARING AND DISTANCES SUBJECT TO FINAL SURVEY

0 5 10 A4  
 1:250

NOTE:  
 ALL CONTOURS HAVE INTERVAL OF 0.5m (CONTOURS ARE APPROXIMATE ONLY)

This plan is provided solely for the purpose of providing an impression of the concept relating to the proposed development called 'The Ranges', as well as the approximate location of existing and proposed third party facilities, services or destinations, and is not intended to be used for any other purpose. Legacy Property does not make any representation or give any warranty in relation to the future development of the site, the staging of any future development or the current or future location or existence of any facilities, services or destinations. The plan is based on the present intention of, and information available to, Legacy Property and the current known requirements of relevant authorities at the time of creation of the plan and details may change due to future circumstances. Any indications of distance or size are approximate and for indicative purposes only and are not to scale. The plan and any matters shown on or inferred from it do not give rise to a legally binding obligation on or representation or warranty by Legacy Property. Legacy Property accepts no liability for any loss or damage arising as a result of any reliance on this plan or its contents.



# THE RANGES

GLEDSDOOD HILLS

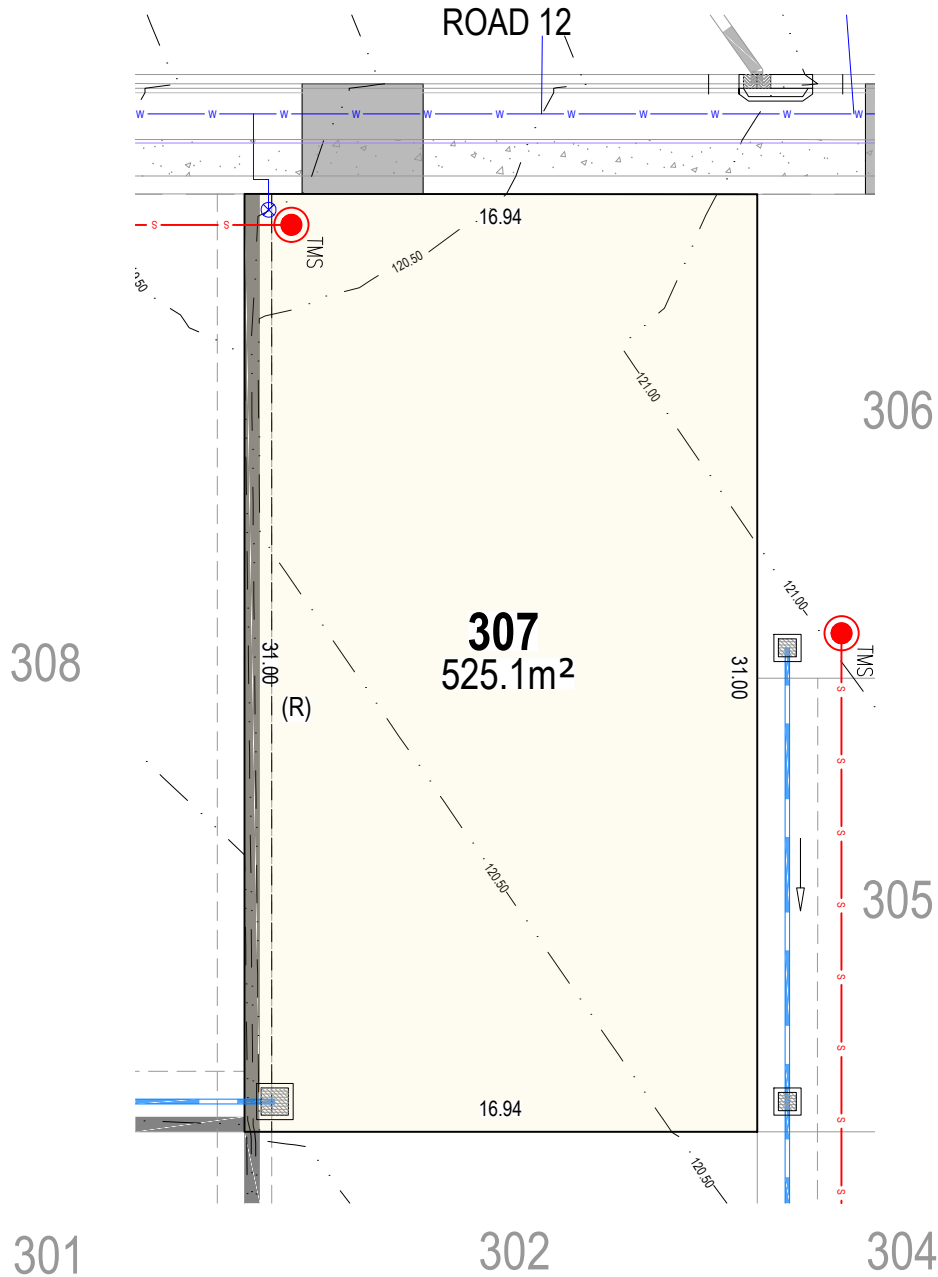

## LEGEND

- |  |                              |     |   |
|--|------------------------------|-----|---|
|  | 101 PROPOSED CONTOUR         | (A) | EASEMENT FOR DRAINAGE (2.00m WIDE)                          |
|  | PROPOSED RETAINING WALL      | (R) | RETAINING WALL RESTRICTION & POSITIVE COVENANT (0.90m WIDE) |
|  | PROPOSED WATER               |     |   |
|  | PROPOSED SEWER               |     |   |
|  | PROPOSED STORMWATER AND PITS |     |   |
|  | PROPOSED EASEMENTS           |     |   |



• AREA SUBJECT TO FINAL SURVEY  
 • BEARING AND DISTANCES SUBJECT TO FINAL SURVEY

0 5 10 A4  
 1:250

NOTE:  
 ALL CONTOURS HAVE INTERVAL OF 0.5m (CONTOURS ARE APPROXIMATE ONLY)

This plan is provided solely for the purpose of providing an impression of the concept relating to the proposed development called 'The Ranges', as well as the approximate location of existing and proposed third party facilities, services or destinations, and is not intended to be used for any other purpose. Legacy Property does not make any representation or give any warranty in relation to the future development of the site, the staging of any future development or the current or future location or existence of any facilities, services or destinations. The plan is based on the present intention of, and information available to, Legacy Property and the current known requirements of relevant authorities at the time of creation of the plan and details may change due to future circumstances. Any indications of distance or size are approximate and for indicative purposes only and are not to scale. The plan and any matters shown on or inferred from it do not give rise to a legally binding obligation on or representation or warranty by Legacy Property. Legacy Property accepts no liability for any loss or damage arising as a result of any reliance on this plan or its contents.



# THE RANGES

GLEDSWOOD HILLS

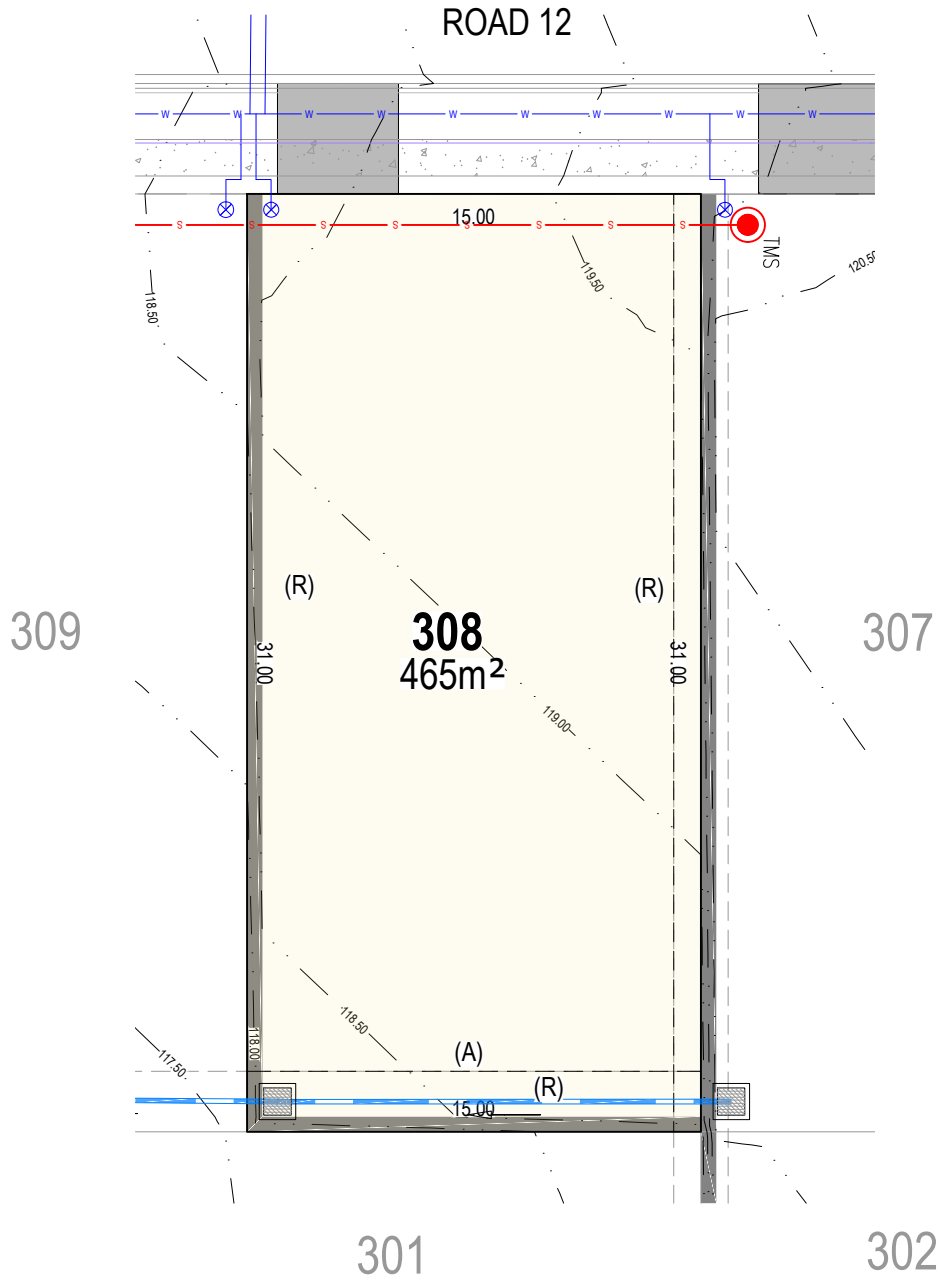

## LEGEND

|     |                              |     |   |
|-----|------------------------------|-----|---|
| 101 | PROPOSED CONTOUR             | (A) | EASEMENT FOR DRAINAGE (2.00m WIDE)                          |
|     | PROPOSED RETAINING WALL      | (R) | RETAINING WALL RESTRICTION & POSITIVE COVENANT (0.90m WIDE) |
|     | PROPOSED WATER               |     |   |
|     | PROPOSED SEWER               |     |   |
|     | PROPOSED STORMWATER AND PITS |     |   |
|     | PROPOSED EASEMENTS           |     |   |



• AREA SUBJECT TO FINAL SURVEY  
• BEARING AND DISTANCES SUBJECT TO FINAL SURVEY

0 5 10 A4  
1:250

NOTE:  
ALL CONTOURS HAVE INTERVAL OF 0.5m (CONTOURS ARE APPROXIMATE ONLY)

This plan is provided solely for the purpose of providing an impression of the concept relating to the proposed development called 'The Ranges', as well as the approximate location of existing and proposed third party facilities, services or destinations, and is not intended to be used for any other purpose. Legacy Property does not make any representation or give any warranty in relation to the future development of the site, the staging of any future development or the current or future location or existence of any facilities, services or destinations. The plan is based on the present intention of, and information available to, Legacy Property and the current known requirements of relevant authorities at the time of creation of the plan and details may change due to future circumstances. Any indications of distance or size are approximate and for indicative purposes only and are not to scale. The plan and any matters shown on or inferred from it do not give rise to a legally binding obligation on or representation or warranty by Legacy Property. Legacy Property accepts no liability for any loss or damage arising as a result of any reliance on this plan or its contents.



# THE RANGES

GLEDSDOOD HILLS

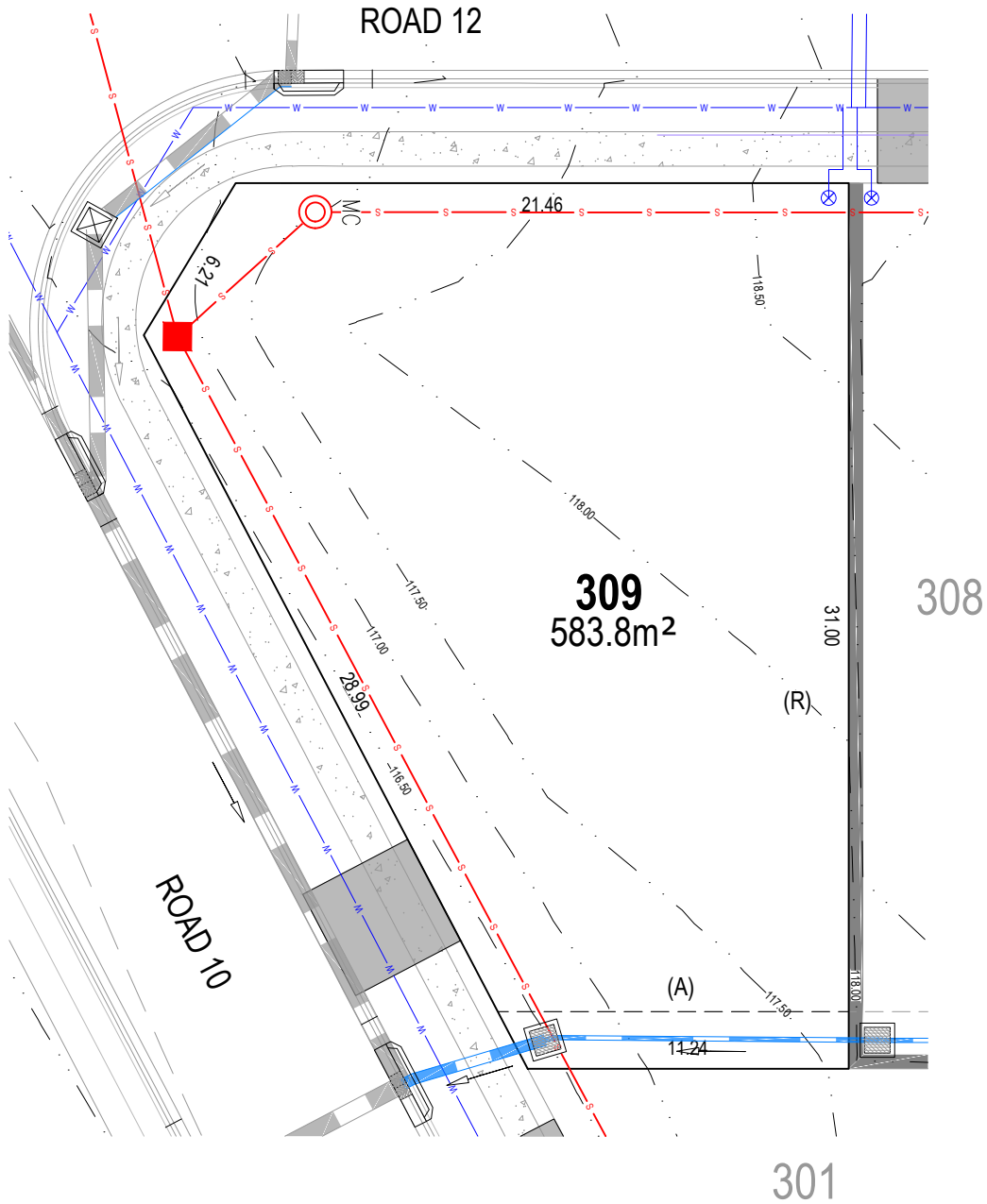

## LEGEND

- |     |                              |     |   |
|-----|------------------------------|-----|---|
| 101 | PROPOSED CONTOUR             | (A) | EASEMENT FOR DRAINAGE (2.00m WIDE)                          |
|     | PROPOSED RETAINING WALL      | (R) | RETAINING WALL RESTRICTION & POSITIVE COVENANT (0.90m WIDE) |
|     | PROPOSED WATER               |     |   |
|     | PROPOSED SEWER               |     |   |
|     | PROPOSED STORMWATER AND PITS |     |   |
|     | PROPOSED EASEMENTS           |     |   |



• AREA SUBJECT TO FINAL SURVEY  
 • BEARING AND DISTANCES SUBJECT TO FINAL SURVEY

0 5 10 A4  
 1:250

NOTE:  
 ALL CONTOURS HAVE INTERVAL OF 0.5m (CONTOURS ARE APPROXIMATE ONLY)

This plan is provided solely for the purpose of providing an impression of the concept relating to the proposed development called 'The Ranges', as well as the approximate location of existing and proposed third party facilities, services or destinations, and is not intended to be used for any other purpose. Legacy Property does not make any representation or give any warranty in relation to the future development of the site, the staging of any future development or the current or future location or existence of any facilities, services or destinations. The plan is based on the present intention of, and information available to, Legacy Property and the current known requirements of relevant authorities at the time of creation of the plan and details may change due to future circumstances. Any indications of distance or size are approximate and for indicative purposes only and are not to scale. The plan and any matters shown on or inferred from it do not give rise to a legally binding obligation on or representation or warranty by Legacy Property. Legacy Property accepts no liability for any loss or damage arising as a result of any reliance on this plan or its contents.

1800 083 990

therangesestate.com.au







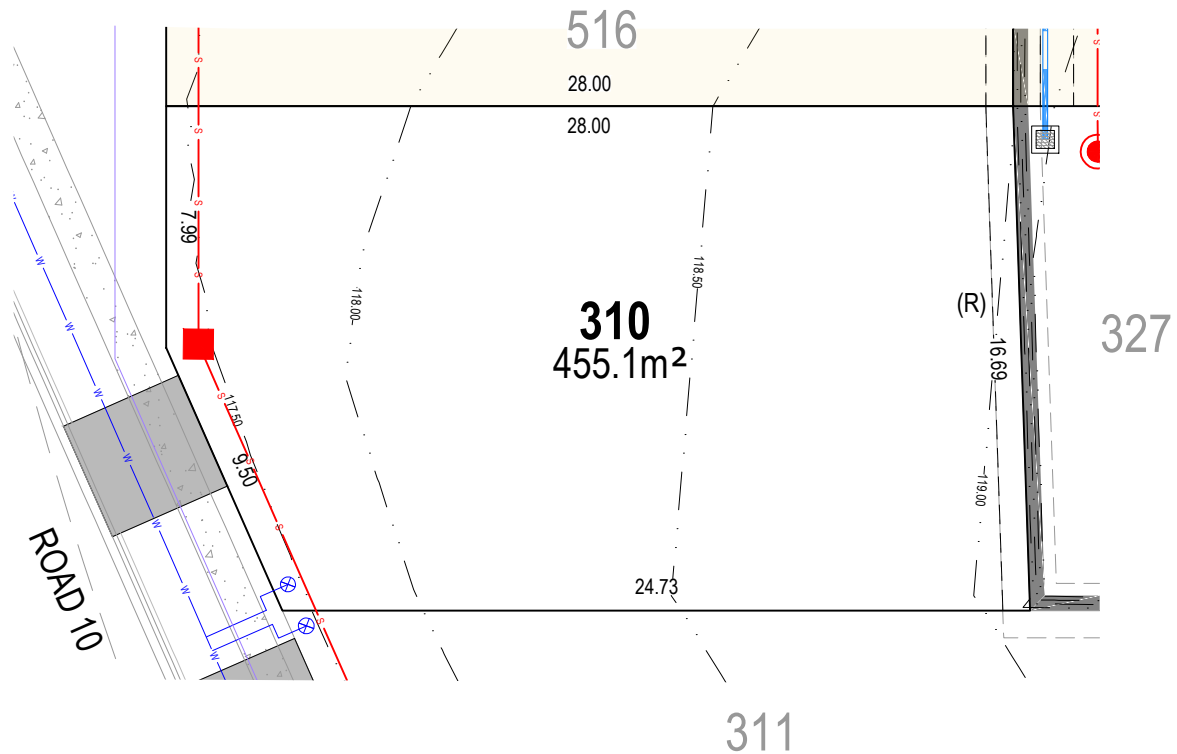

LEGACYPROPERTY

# THE RANGES

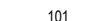
GLEDSDOOD HILLS



## LEGEND

|  |                              |     |   |
|--|------------------------------|-----|---|
|  101 | PROPOSED CONTOUR             | (A) | EASEMENT FOR DRAINAGE (2.00m WIDE)                          |
|      | PROPOSED RETAINING WALL      | (R) | RETAINING WALL RESTRICTION & POSITIVE COVENANT (0.90m WIDE) |
|      | PROPOSED WATER               |     |   |
|      | PROPOSED SEWER               |     |   |
|      | PROPOSED STORMWATER AND PITS |     |   |
|      | PROPOSED EASEMENTS           |     |   |



\* AREA SUBJECT TO FINAL SURVEY  
 \* BEARING AND DISTANCES SUBJECT TO FINAL SURVEY  
 0 5 10 A4  
 1:250

NOTE:  
ALL CONTOURS HAVE INTERVAL OF 0.5m (CONTOURS ARE APPROXIMATE ONLY)

This plan is provided solely for the purpose of providing an impression of the concept relating to the proposed development called 'The Ranges', as well as the approximate location of existing and proposed third party facilities, services or destinations, and is not intended to be used for any other purpose. Legacy Property does not make any representation or give any warranty in relation to the future development of the site, the staging of any future development or the current or future location or existence of any facilities, services or destinations. The plan is based on the present intention of, and information available to, Legacy Property and the current known requirements of relevant authorities at the time of creation of the plan and details may change due to future circumstances. Any indications of distance or size are approximate and for indicative purposes only and are not to scale. The plan and any matters shown on or inferred from it do not give rise to a legally binding obligation on or representation or warranty by Legacy Property. Legacy Property accepts no liability for any loss or damage arising as a result of any reliance on this plan or its contents.



# THE RANGES

GLEDSDOOD HILLS

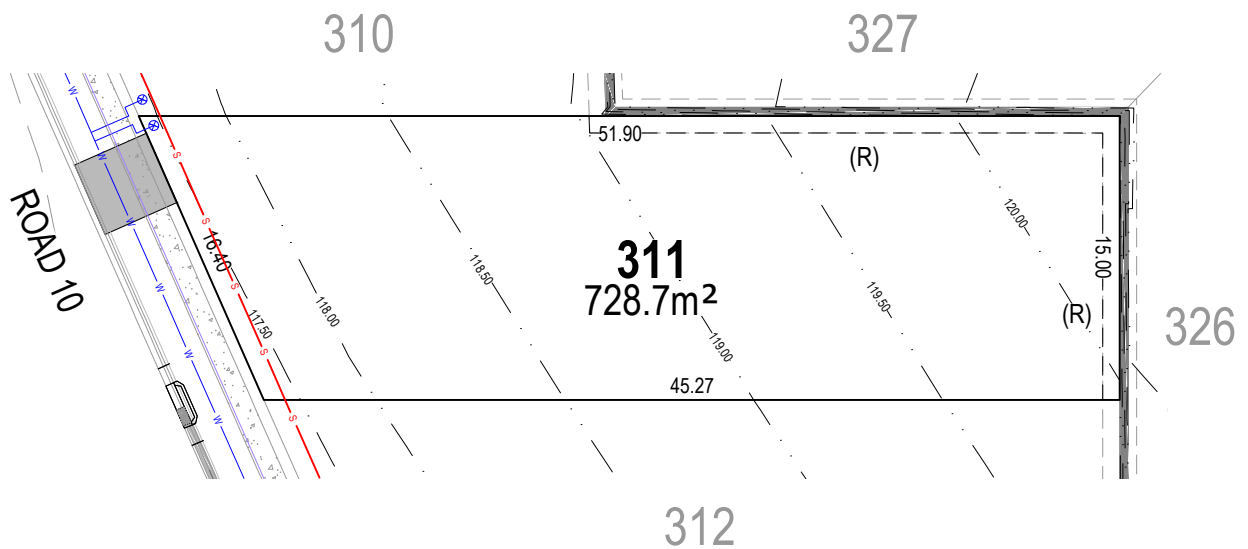

## LEGEND

|  |                              |     |   |
|--|------------------------------|-----|---|
|  | 101 PROPOSED CONTOUR         | (A) | EASEMENT FOR DRAINAGE (2.00m WIDE)                          |
|  | PROPOSED RETAINING WALL      | (R) | RETAINING WALL RESTRICTION & POSITIVE COVENANT (0.90m WIDE) |
|  | PROPOSED WATER               |     |   |
|  | PROPOSED SEWER               |     |   |
|  | PROPOSED STORMWATER AND PITS |     |   |
|  | PROPOSED EASEMENTS           |     |   |



\* AREA SUBJECT TO FINAL SURVEY  
 \* BEARING AND DISTANCES SUBJECT TO FINAL SURVEY



A4  
1:400

NOTE:  
 ALL CONTOURS HAVE INTERVAL OF 0.5m (CONTOURS ARE APPROXIMATE ONLY)

This plan is provided solely for the purpose of providing an impression of the concept relating to the proposed development called 'The Ranges', as well as the approximate location of existing and proposed third party facilities, services or destinations, and is not intended to be used for any other purpose. Legacy Property does not make any representation or give any warranty in relation to the future development of the site, the staging of any future development or the current or future location or existence of any facilities, services or destinations. The plan is based on the present intention of, and information available to, Legacy Property and the current known requirements of relevant authorities at the time of creation of the plan and details may change due to future circumstances. Any indications of distance or size are approximate and for indicative purposes only and are not to scale. The plan and any matters shown on or inferred from it do not give rise to a legally binding obligation on or representation or warranty by Legacy Property. Legacy Property accepts no liability for any loss or damage arising as a result of any reliance on this plan or its contents.

1800 083 990

therangesestate.com.au



LEGACYPROPERTY

# THE RANGES

GLEDSDOOD HILLS

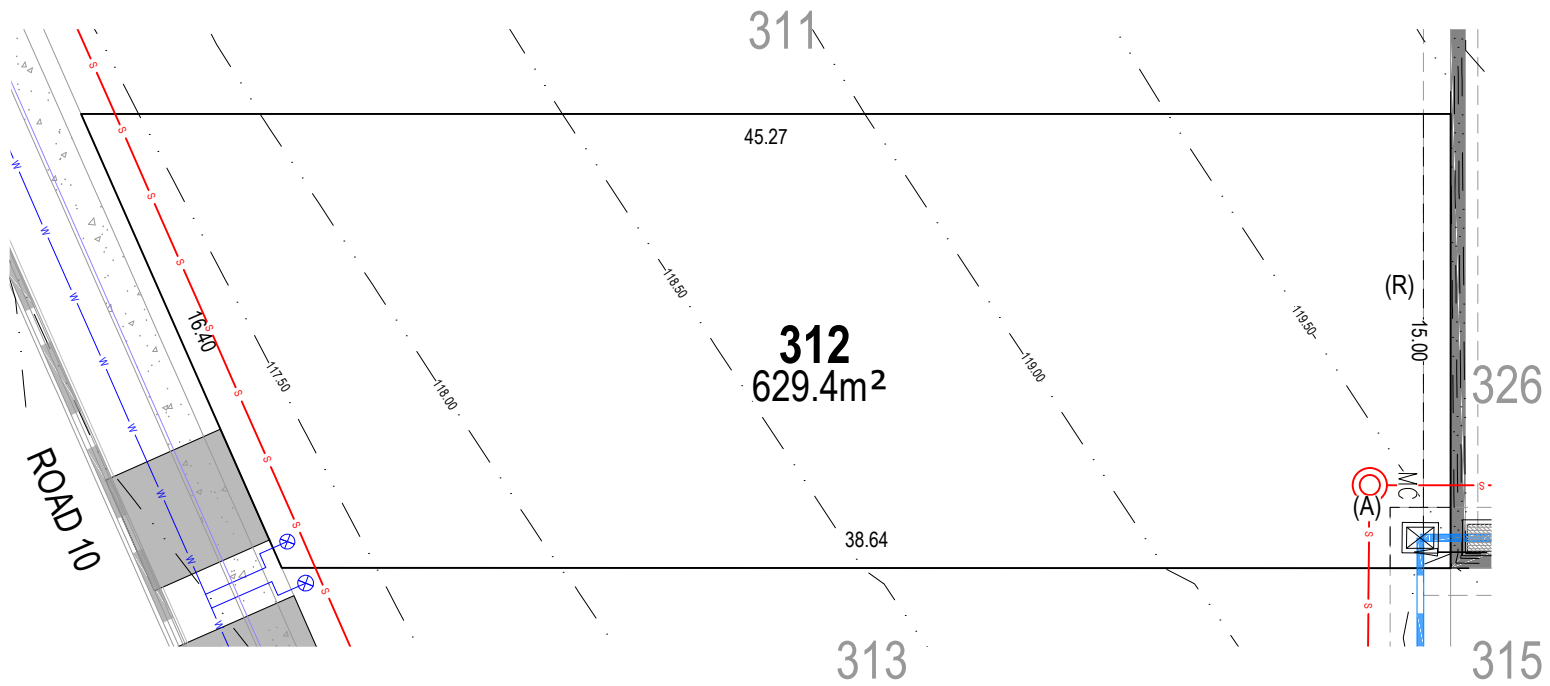

## LEGEND

- |  |     |                              |     |   |
|--|-----|------------------------------|-----|---|
|  | 101 | PROPOSED CONTOUR             | (A) | EASEMENT FOR DRAINAGE (2.00m WIDE)                          |
|  |     | PROPOSED RETAINING WALL      | (R) | RETAINING WALL RESTRICTION & POSITIVE COVENANT (0.90m WIDE) |
|  |     | PROPOSED WATER               |     |   |
|  |     | PROPOSED SEWER               |     |   |
|  |     | PROPOSED STORMWATER AND PITS |     |   |
|  |     | PROPOSED EASEMENTS           |     |   |



• AREA SUBJECT TO FINAL SURVEY  
 • BEARING AND DISTANCES SUBJECT TO FINAL SURVEY

0 5 10 A4  
 1:250

NOTE:  
 ALL CONTOURS HAVE INTERVAL OF 0.5m (CONTOURS ARE APPROXIMATE ONLY)

This plan is provided solely for the purpose of providing an impression of the concept relating to the proposed development called 'The Ranges', as well as the approximate location of existing and proposed third party facilities, services or destinations, and is not intended to be used for any other purpose. Legacy Property does not make any representation or give any warranty in relation to the future development of the site, the staging of any future development or the current or future location or existence of any facilities, services or destinations. The plan is based on the present intention of, and information available to, Legacy Property and the current known requirements of relevant authorities at the time of creation of the plan and details may change due to future circumstances. Any indications of distance or size are approximate and for indicative purposes only and are not to scale. The plan and any matters shown on or inferred from it do not give rise to a legally binding obligation on or representation or warranty by Legacy Property. Legacy Property accepts no liability for any loss or damage arising as a result of any reliance on this plan or its contents.

1800 083 990  
 therangesestate.com.au



LEGACYPROPERTY



# THE RANGES

GLEDSDOOD HILLS

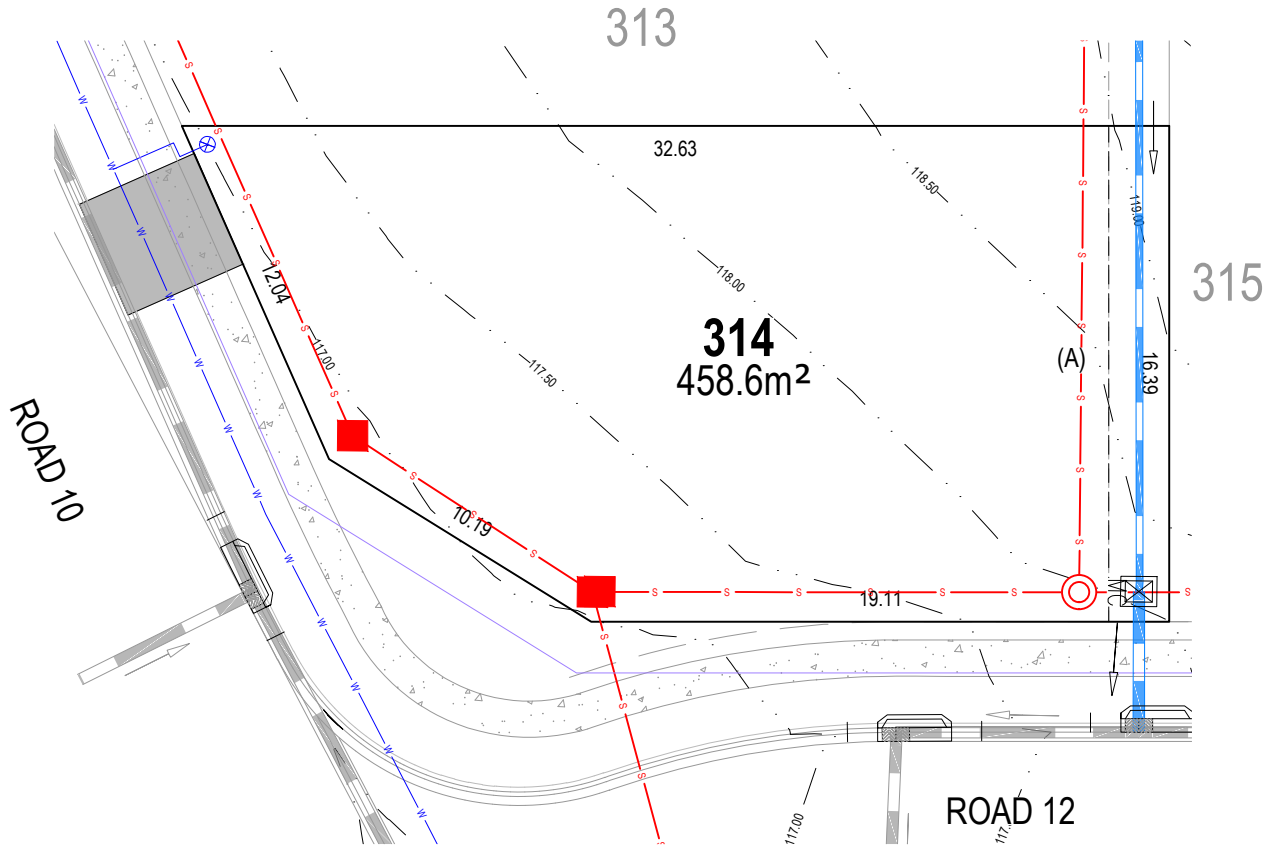

## LEGEND

|  |     |                              |     |   |
|--|-----|------------------------------|-----|---|
|  | 101 | PROPOSED CONTOUR             | (A) | EASEMENT FOR DRAINAGE (2.00m WIDE)                          |
|  |     | PROPOSED RETAINING WALL      | (R) | RETAINING WALL RESTRICTION & POSITIVE COVENANT (0.90m WIDE) |
|  |     | PROPOSED WATER               |     |   |
|  |     | PROPOSED SEWER               |     |   |
|  |     | PROPOSED STORMWATER AND PITS |     |   |
|  |     | PROPOSED EASEMENTS           |     |   |



• AREA SUBJECT TO FINAL SURVEY  
• BEARING AND DISTANCES SUBJECT TO FINAL SURVEY

0 5 10 A4  
1:250

NOTE:  
ALL CONTOURS HAVE INTERVAL OF 0.5m (CONTOURS ARE APPROXIMATE ONLY)

This plan is provided solely for the purpose of providing an impression of the concept relating to the proposed development called 'The Ranges', as well as the approximate location of existing and proposed third party facilities, services or destinations, and is not intended to be used for any other purpose. Legacy Property does not make any representation or give any warranty in relation to the future development of the site, the staging of any future development or the current or future location or existence of any facilities, services or destinations. The plan is based on the present intention of, and information available to, Legacy Property and the current known requirements of relevant authorities at the time of creation of the plan and details may change due to future circumstances. Any indications of distance or size are approximate and for indicative purposes only and are not to scale. The plan and any matters shown on or inferred from it do not give rise to a legally binding obligation on or representation or warranty by Legacy Property. Legacy Property accepts no liability for any loss or damage arising as a result of any reliance on this plan or its contents.

1800 083 990  
therangesestate.com.au



LEGACYPROPERTY

# THE RANGES

GLEDSDOOD HILLS

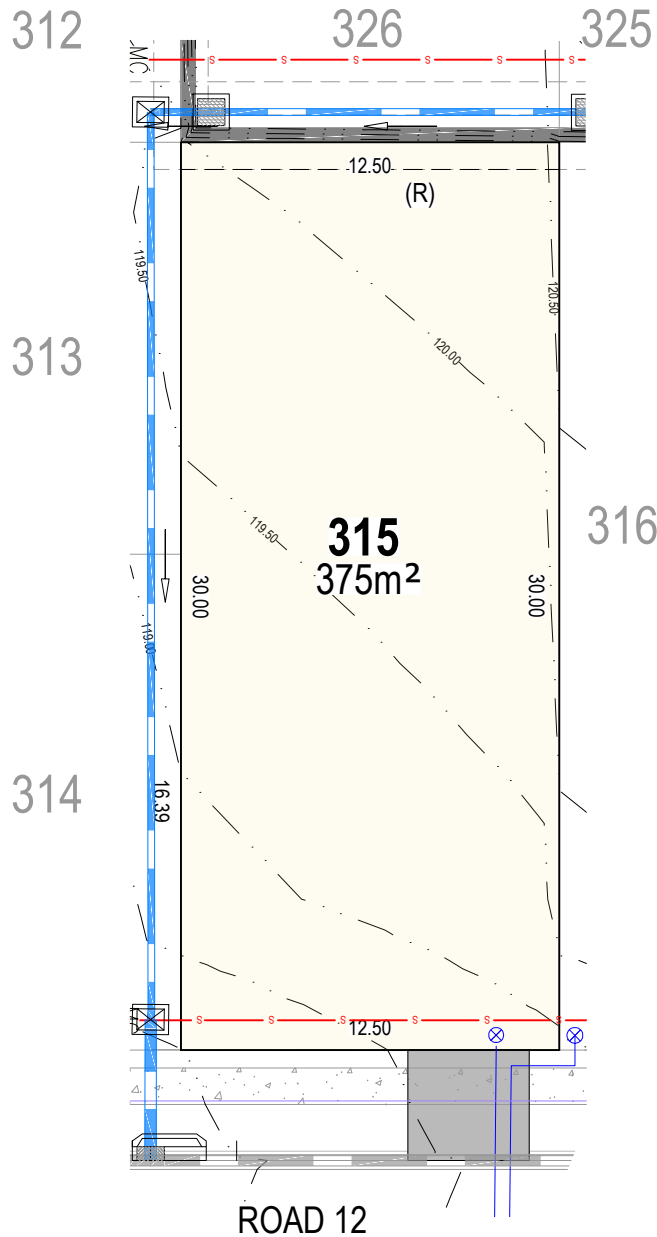

## LEGEND

- |     |                              |     |   |
|-----|------------------------------|-----|---|
| 101 | PROPOSED CONTOUR             | (A) | EASEMENT FOR DRAINAGE (2.00m WIDE)                          |
|     | PROPOSED RETAINING WALL      | (R) | RETAINING WALL RESTRICTION & POSITIVE COVENANT (0.90m WIDE) |
|     | PROPOSED WATER               |     |   |
|     | PROPOSED SEWER               |     |   |
|     | PROPOSED STORMWATER AND PITS |     |   |
|     | PROPOSED EASEMENTS           |     |   |



• AREA SUBJECT TO FINAL SURVEY  
 • BEARING AND DISTANCES SUBJECT TO FINAL SURVEY

0 5 10 A4  
 1:250

NOTE:  
 ALL CONTOURS HAVE INTERVAL OF 0.5m (CONTOURS ARE APPROXIMATE ONLY)

This plan is provided solely for the purpose of providing an impression of the concept relating to the proposed development called 'The Ranges', as well as the approximate location of existing and proposed third party facilities, services or destinations, and is not intended to be used for any other purpose. Legacy Property does not make any representation or give any warranty in relation to the future development of the site, the staging of any future development or the current or future location or existence of any facilities, services or destinations. The plan is based on the present intention of, and information available to, Legacy Property and the current known requirements of relevant authorities at the time of creation of the plan and details may change due to future circumstances. Any indications of distance or size are approximate and for indicative purposes only and are not to scale. The plan and any matters shown on or inferred from it do not give rise to a legally binding obligation on or representation or warranty by Legacy Property. Legacy Property accepts no liability for any loss or damage arising as a result of any reliance on this plan or its contents.

1800 083 990  
 therangesestate.com.au



LEGACYPROPERTY

# THE RANGES

GLEDSDOOD HILLS

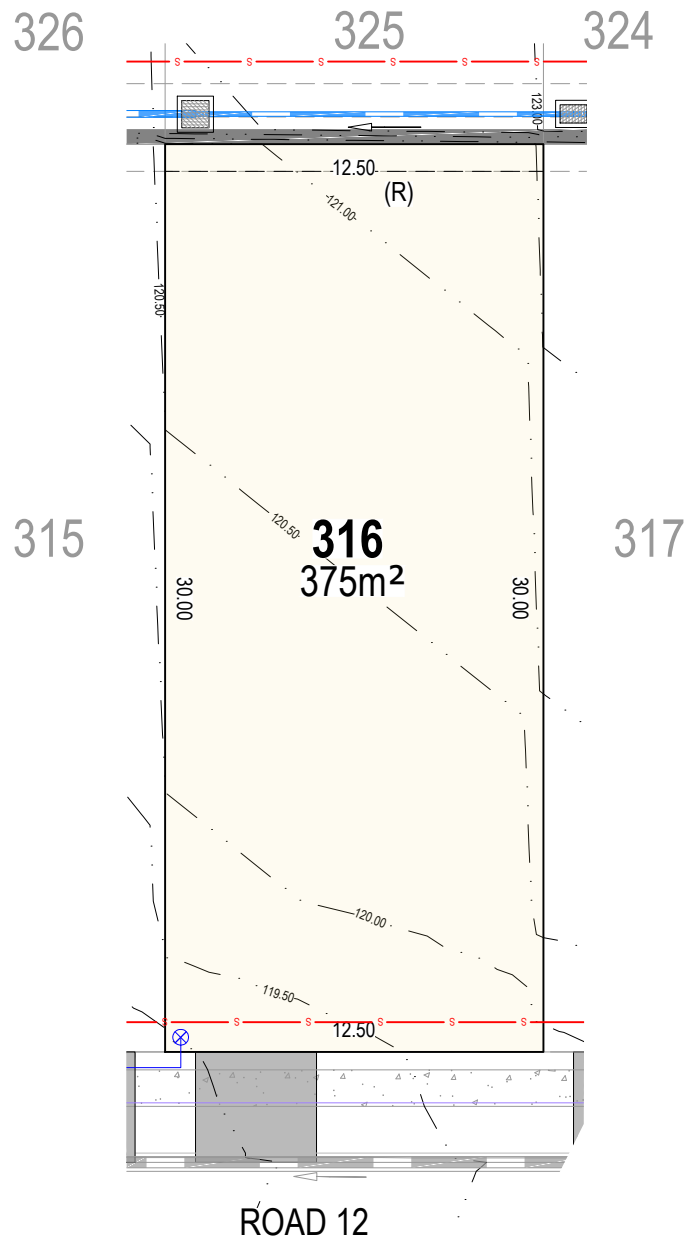

## LEGEND

|     |                              |     |   |
|-----|------------------------------|-----|---|
| 101 | PROPOSED CONTOUR             | (A) | EASEMENT FOR DRAINAGE (2.00m WIDE)                          |
|     | PROPOSED RETAINING WALL      | (R) | RETAINING WALL RESTRICTION & POSITIVE COVENANT (0.90m WIDE) |
|     | PROPOSED WATER               |     |   |
|     | PROPOSED SEWER               |     |   |
|     | PROPOSED STORMWATER AND PITS |     |   |
|     | PROPOSED EASEMENTS           |     |   |



• AREA SUBJECT TO FINAL SURVEY  
• BEARING AND DISTANCES SUBJECT TO FINAL SURVEY

0 5 10 A4  
1:250

NOTE:  
ALL CONTOURS HAVE INTERVAL OF 0.5m (CONTOURS ARE APPROXIMATE ONLY)

This plan is provided solely for the purpose of providing an impression of the concept relating to the proposed development called 'The Ranges', as well as the approximate location of existing and proposed third party facilities, services or destinations, and is not intended to be used for any other purpose. Legacy Property does not make any representation or give any warranty in relation to the future development of the site, the staging of any future development or the current or future location or existence of any facilities, services or destinations. The plan is based on the present intention of, and information available to, Legacy Property and the current known requirements of relevant authorities at the time of creation of the plan and details may change due to future circumstances. Any indications of distance or size are approximate and for indicative purposes only and are not to scale. The plan and any matters shown on or inferred from it do not give rise to a legally binding obligation on or representation or warranty by Legacy Property. Legacy Property accepts no liability for any loss or damage arising as a result of any reliance on this plan or its contents.

1800 083 990  
therangesestate.com.au



LEGACYPROPERTY

# THE RANGES

GLEDSDWOOD HILLS

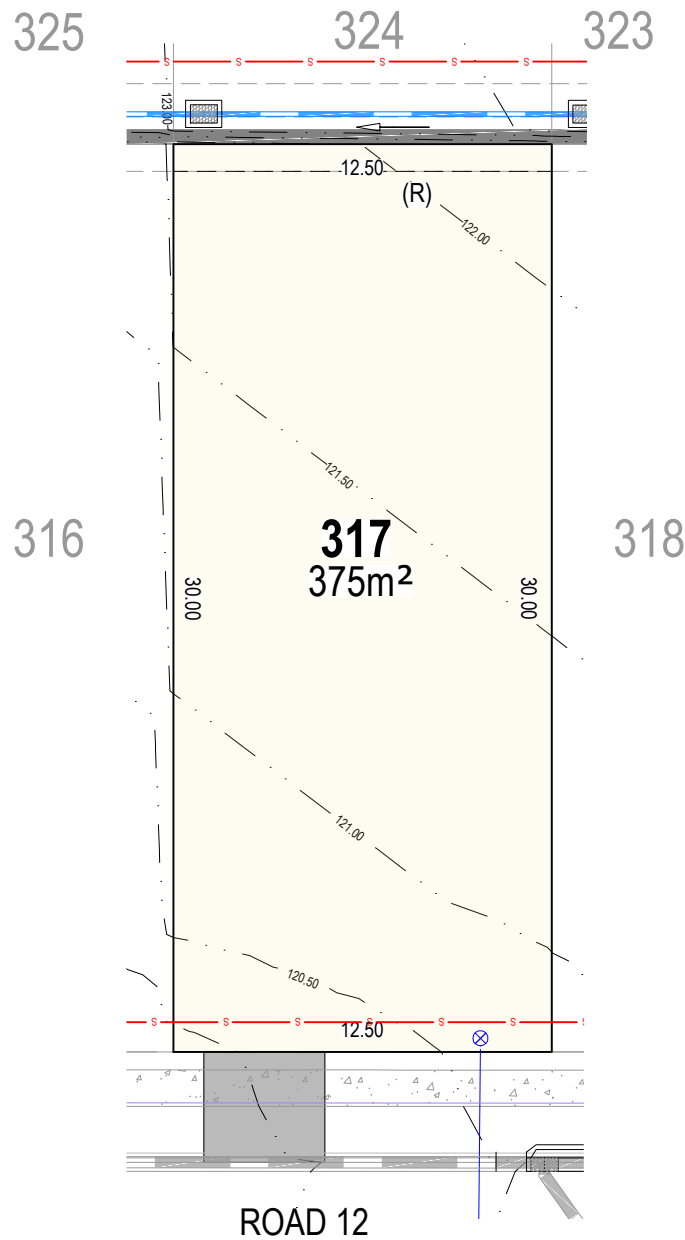

## LEGEND

- |  |                              |     |   |
|--|------------------------------|-----|---|
|  | 101 PROPOSED CONTOUR         | (A) | EASEMENT FOR DRAINAGE (2.00m WIDE)                          |
|  | PROPOSED RETAINING WALL      | (R) | RETAINING WALL RESTRICTION & POSITIVE COVENANT (0.90m WIDE) |
|  | PROPOSED WATER               |     |   |
|  | PROPOSED SEWER               |     |   |
|  | PROPOSED STORMWATER AND PITS |     |   |
|  | PROPOSED EASEMENTS           |     |   |



• AREA SUBJECT TO FINAL SURVEY  
 • BEARING AND DISTANCES SUBJECT TO FINAL SURVEY

0 5 10 A4  
 1:250

NOTE:  
 ALL CONTOURS HAVE INTERVAL OF 0.5m (CONTOURS ARE APPROXIMATE ONLY)

This plan is provided solely for the purpose of providing an impression of the concept relating to the proposed development called 'The Ranges', as well as the approximate location of existing and proposed third party facilities, services or destinations, and is not intended to be used for any other purpose. Legacy Property does not make any representation or give any warranty in relation to the future development of the site, the staging of any future development or the current or future location or existence of any facilities, services or destinations. The plan is based on the present intention of, and information available to, Legacy Property and the current known requirements of relevant authorities at the time of creation of the plan and details may change due to future circumstances. Any indications of distance or size are approximate and for indicative purposes only and are not to scale. The plan and any matters shown on or inferred from it do not give rise to a legally binding obligation on or representation or warranty by Legacy Property. Legacy Property accepts no liability for any loss or damage arising as a result of any reliance on this plan or its contents.



# THE RANGES

GLEDSDOOD HILLS

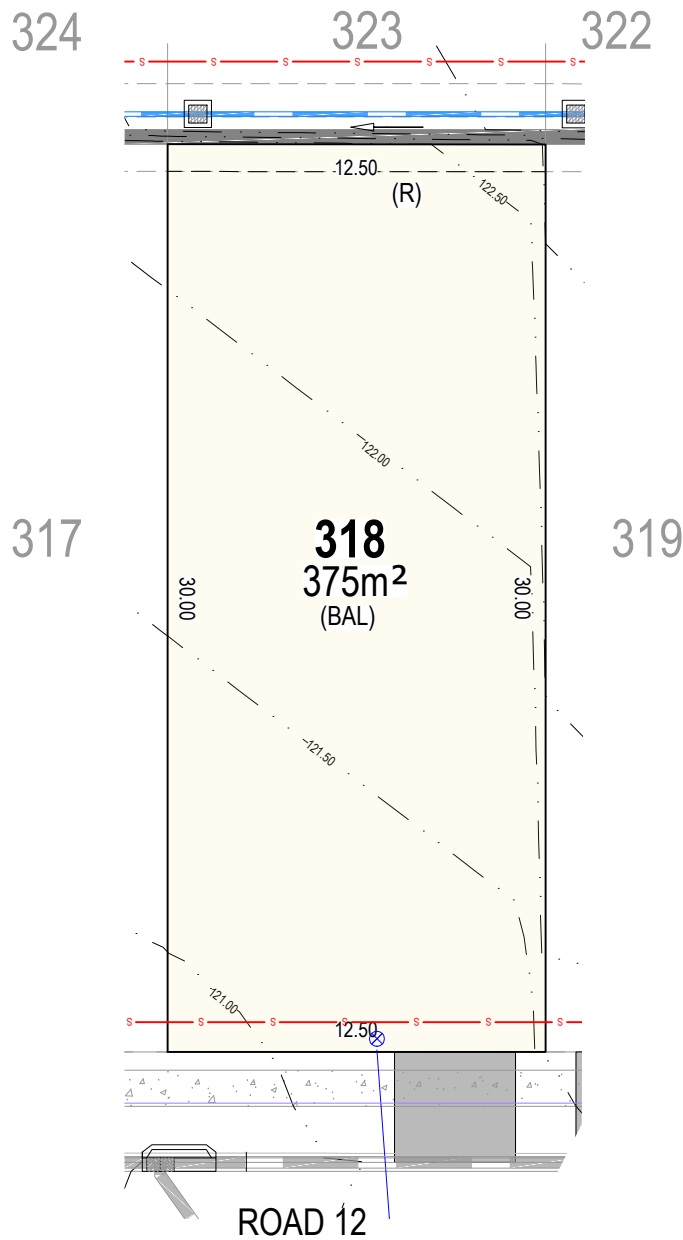

## LEGEND

|  |                              |       |   |
|--|------------------------------|-------|---|
|  | 101 PROPOSED CONTOUR         | (A)   | EASEMENT FOR DRAINAGE (2.00m WIDE)                          |
|  | PROPOSED RETAINING WALL      | (R)   | RETAINING WALL RESTRICTION & POSITIVE COVENANT (0.90m WIDE) |
|  | PROPOSED WATER               | (BAL) | BUSHFIRE ATTACK LEVEL - 12.5                                |
|  | PROPOSED SEWER               |       |   |
|  | PROPOSED STORMWATER AND PITS |       |   |
|  | PROPOSED EASEMENTS           |       |   |



• AREA SUBJECT TO FINAL SURVEY  
• BEARING AND DISTANCES SUBJECT TO FINAL SURVEY

0 5 10 A4  
1:250

NOTE:  
ALL CONTOURS HAVE INTERVAL OF 0.5m (CONTOURS ARE APPROXIMATE ONLY)

This plan is provided solely for the purpose of providing an impression of the concept relating to the proposed development called 'The Ranges', as well as the approximate location of existing and proposed third party facilities, services or destinations, and is not intended to be used for any other purpose. Legacy Property does not make any representation or give any warranty in relation to the future development of the site, the staging of any future development or the current or future location or existence of any facilities, services or destinations. The plan is based on the present intention of, and information available to, Legacy Property and the current known requirements of relevant authorities at the time of creation of the plan and details may change due to future circumstances. Any indications of distance or size are approximate and for indicative purposes only and are not to scale. The plan and any matters shown on or inferred from it do not give rise to a legally binding obligation on or representation or warranty by Legacy Property. Legacy Property accepts no liability for any loss or damage arising as a result of any reliance on this plan or its contents.

1800 083 990

therangesestate.com.au



LEGACYPROPERTY

# THE RANGES

GLEDSDOOD HILLS

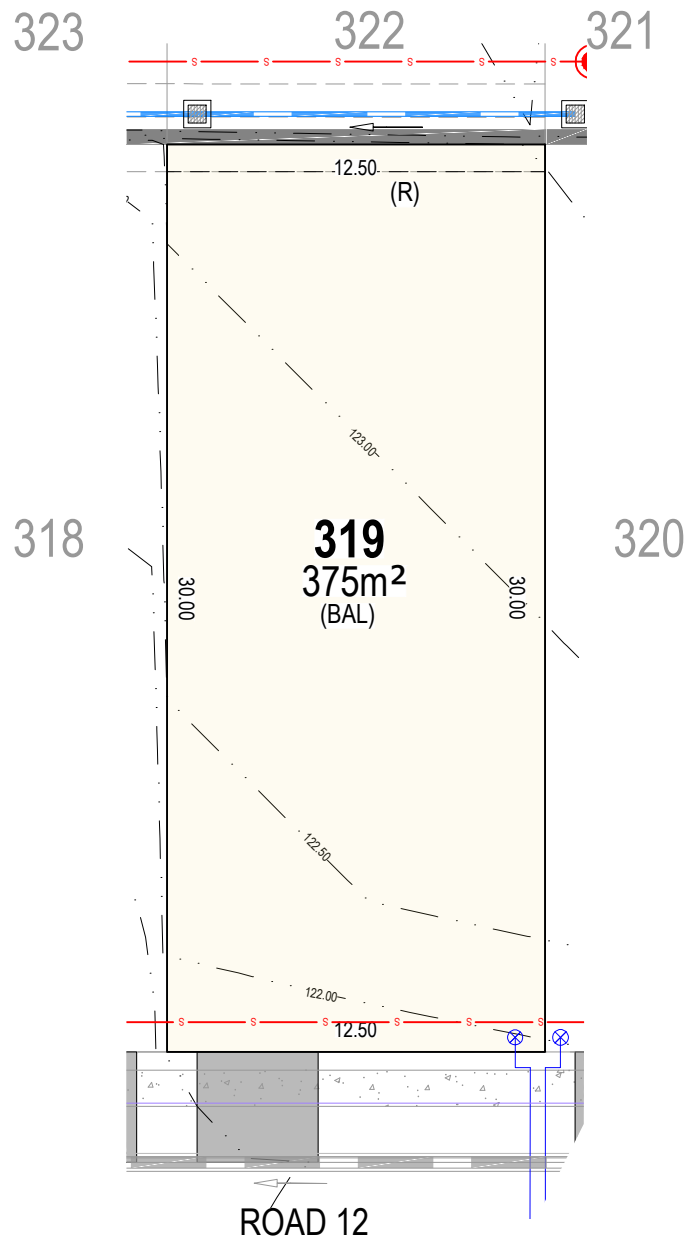

## LEGEND

|     |                              |       |   |
|-----|------------------------------|-------|---|
| 101 | PROPOSED CONTOUR             | (A)   | EASEMENT FOR DRAINAGE (2.00m WIDE)                          |
|     | PROPOSED RETAINING WALL      | (R)   | RETAINING WALL RESTRICTION & POSITIVE COVENANT (0.90m WIDE) |
|     | PROPOSED WATER               | (BAL) | BUSHFIRE ATTACK LEVEL - 12.5                                |
|     | PROPOSED SEWER               |       |   |
|     | PROPOSED STORMWATER AND PITS |       |   |
|     | PROPOSED EASEMENTS           |       |   |



• AREA SUBJECT TO FINAL SURVEY  
• BEARING AND DISTANCES SUBJECT TO FINAL SURVEY

0 5 10 A4  
1:250

NOTE:  
ALL CONTOURS HAVE INTERVAL OF 0.5m (CONTOURS ARE APPROXIMATE ONLY)

This plan is provided solely for the purpose of providing an impression of the concept relating to the proposed development called 'The Ranges', as well as the approximate location of existing and proposed third party facilities, services or destinations, and is not intended to be used for any other purpose. Legacy Property does not make any representation or give any warranty in relation to the future development of the site, the staging of any future development or the current or future location or existence of any facilities, services or destinations. The plan is based on the present intention of, and information available to, Legacy Property and the current known requirements of relevant authorities at the time of creation of the plan and details may change due to future circumstances. Any indications of distance or size are approximate and for indicative purposes only and are not to scale. The plan and any matters shown on or inferred from it do not give rise to a legally binding obligation on or representation or warranty by Legacy Property. Legacy Property accepts no liability for any loss or damage arising as a result of any reliance on this plan or its contents.

1800 083 990

therangesestate.com.au



LEGACYPROPERTY

# THE RANGES

GLEDSDOOD HILLS

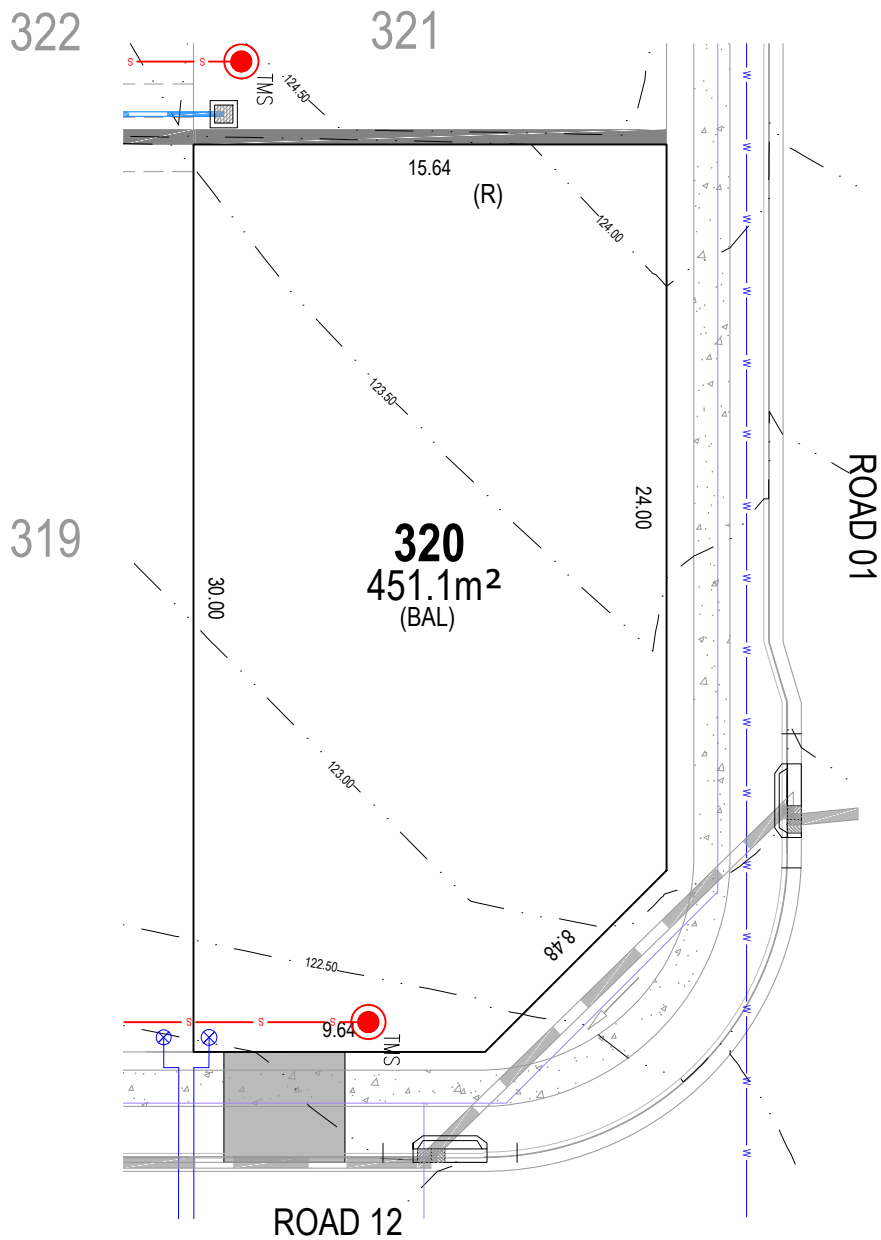

## LEGEND

|  |                              |       |   |
|--|------------------------------|-------|---|
|  | 101 PROPOSED CONTOUR         | (A)   | EASEMENT FOR DRAINAGE (2.00m WIDE)                          |
|  | PROPOSED RETAINING WALL      | (R)   | RETAINING WALL RESTRICTION & POSITIVE COVENANT (0.90m WIDE) |
|  | PROPOSED WATER               | (BAL) | BUSHFIRE ATTACK LEVEL - 12.5                                |
|  | PROPOSED SEWER               |       |   |
|  | PROPOSED STORMWATER AND PITS |       |   |
|  | PROPOSED EASEMENTS           |       |   |



• AREA SUBJECT TO FINAL SURVEY  
• BEARING AND DISTANCES SUBJECT TO FINAL SURVEY

0 5 10 A4  
1:250

NOTE:  
ALL CONTOURS HAVE INTERVAL OF 0.5m (CONTOURS ARE APPROXIMATE ONLY)

This plan is provided solely for the purpose of providing an impression of the concept relating to the proposed development called 'The Ranges', as well as the approximate location of existing and proposed third party facilities, services or destinations, and is not intended to be used for any other purpose. Legacy Property does not make any representation or give any warranty in relation to the future development of the site, the staging of any future development or the current or future location or existence of any facilities, services or destinations. The plan is based on the present intention of, and information available to, Legacy Property and the current known requirements of relevant authorities at the time of creation of the plan and details may change due to future circumstances. Any indications of distance or size are approximate and for indicative purposes only and are not to scale. The plan and any matters shown on or inferred from it do not give rise to a legally binding obligation on or representation or warranty by Legacy Property. Legacy Property accepts no liability for any loss or damage arising as a result of any reliance on this plan or its contents.

1800 083 990

therangesestate.com.au



LEGACYPROPERTY

# THE RANGES

GLEDSDOOD HILLS

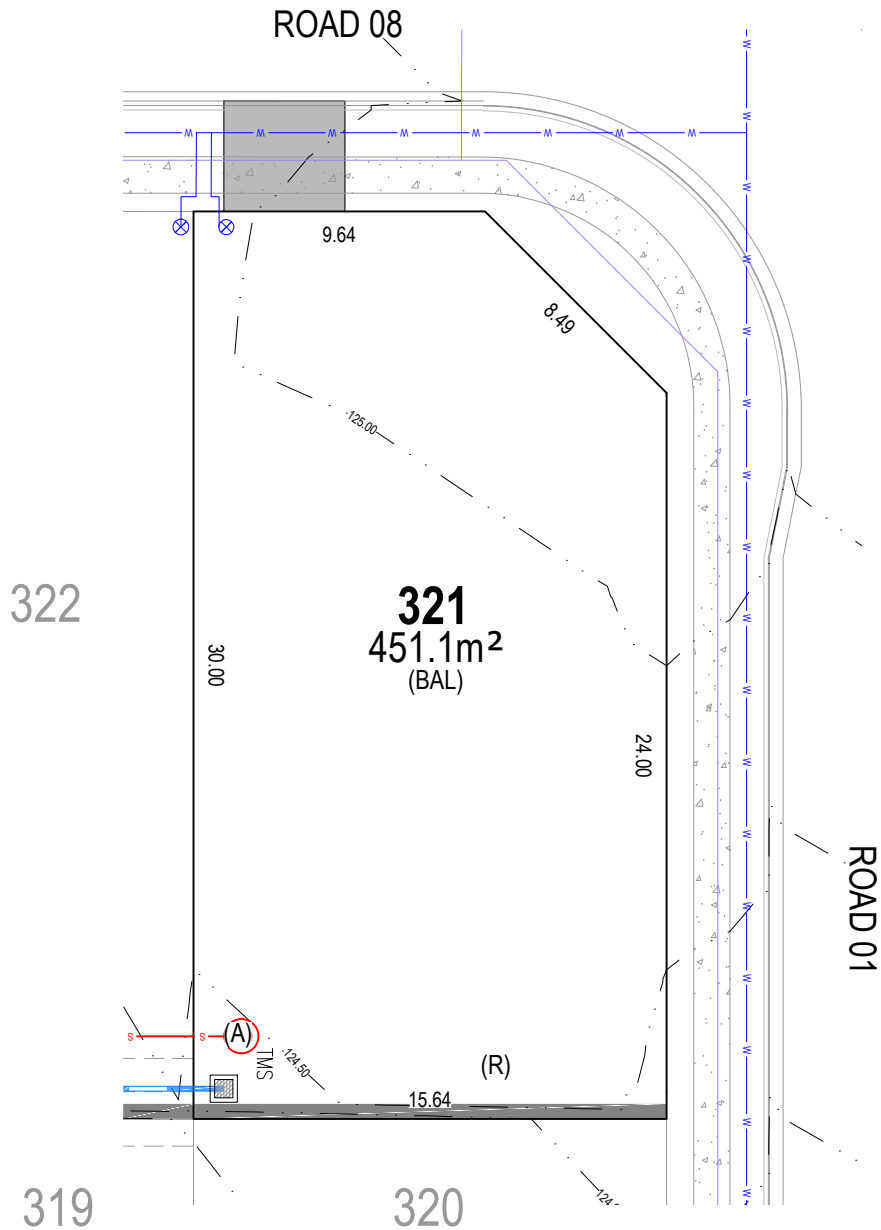

## LEGEND

|     |                              |       |   |
|-----|------------------------------|-------|---|
| 101 | PROPOSED CONTOUR             | (A)   | EASEMENT FOR DRAINAGE (2.00m WIDE)                          |
|     | PROPOSED RETAINING WALL      | (R)   | RETAINING WALL RESTRICTION & POSITIVE COVENANT (0.90m WIDE) |
|     | PROPOSED WATER               | (BAL) | BUSHFIRE ATTACK LEVEL - 12.5                                |
|     | PROPOSED SEWER               |       |   |
|     | PROPOSED STORMWATER AND PITS |       |   |
|     | PROPOSED EASEMENTS           |       |   |



• AREA SUBJECT TO FINAL SURVEY  
 • BEARING AND DISTANCES SUBJECT TO FINAL SURVEY

0 5 10 A4  
 1:250

NOTE:  
 ALL CONTOURS HAVE INTERVAL OF 0.5m (CONTOURS ARE APPROXIMATE ONLY)

This plan is provided solely for the purpose of providing an impression of the concept relating to the proposed development called 'The Ranges', as well as the approximate location of existing and proposed third party facilities, services or destinations, and is not intended to be used for any other purpose. Legacy Property does not make any representation or give any warranty in relation to the future development of the site, the staging of any future development or the current or future location or existence of any facilities, services or destinations. The plan is based on the present intention of, and information available to, Legacy Property and the current known requirements of relevant authorities at the time of creation of the plan and details may change due to future circumstances. Any indications of distance or size are approximate and for indicative purposes only and are not to scale. The plan and any matters shown on or inferred from it do not give rise to a legally binding obligation on or representation or warranty by Legacy Property. Legacy Property accepts no liability for any loss or damage arising as a result of any reliance on this plan or its contents.

1800 083 990

therangesestate.com.au



LEGACYPROPERTY

# THE RANGES

GLEDSDOOD HILLS

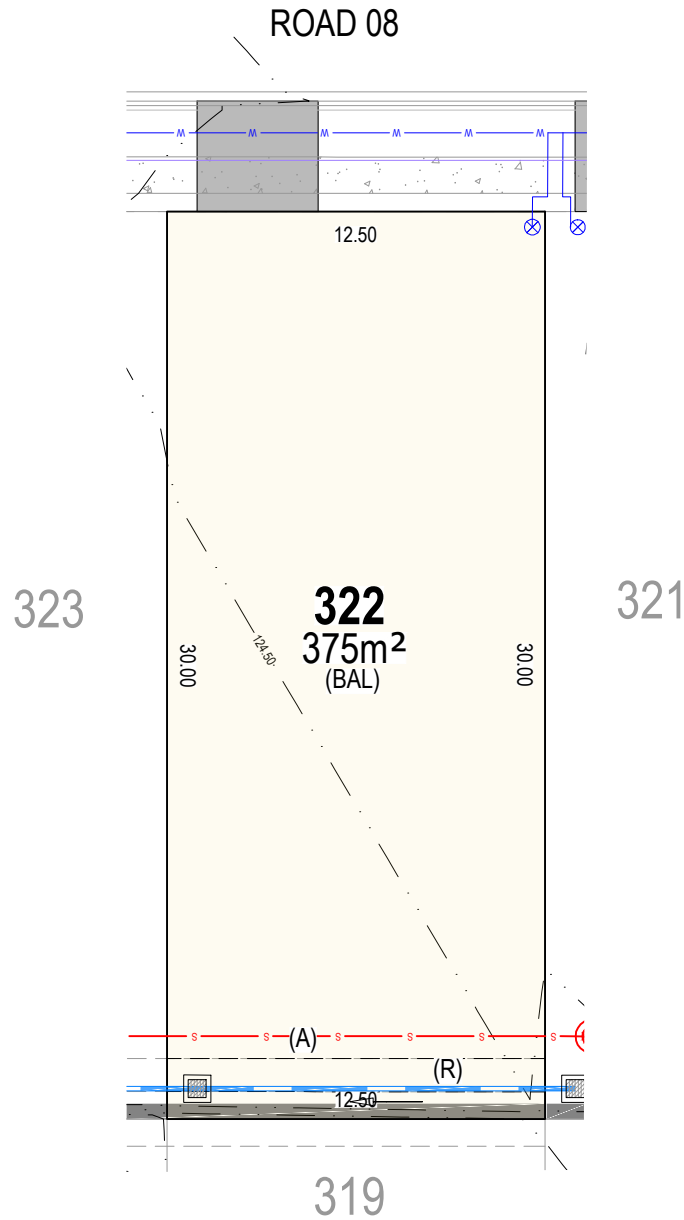

## LEGEND

|     |                              |       |   |
|-----|------------------------------|-------|---|
| 101 | PROPOSED CONTOUR             | (A)   | EASEMENT FOR DRAINAGE (2.00m WIDE)                          |
|     | PROPOSED RETAINING WALL      | (R)   | RETAINING WALL RESTRICTION & POSITIVE COVENANT (0.90m WIDE) |
|     | PROPOSED WATER               | (BAL) | BUSHFIRE ATTACK LEVEL - 12.5                                |
|     | PROPOSED SEWER               |       |   |
|     | PROPOSED STORMWATER AND PITS |       |   |
|     | PROPOSED EASEMENTS           |       |   |



• AREA SUBJECT TO FINAL SURVEY  
• BEARING AND DISTANCES SUBJECT TO FINAL SURVEY

0 5 10 A4  
1:250

NOTE:  
ALL CONTOURS HAVE INTERVAL OF 0.5m (CONTOURS ARE APPROXIMATE ONLY)

This plan is provided solely for the purpose of providing an impression of the concept relating to the proposed development called 'The Ranges', as well as the approximate location of existing and proposed third party facilities, services or destinations, and is not intended to be used for any other purpose. Legacy Property does not make any representation or give any warranty in relation to the future development of the site, the staging of any future development or the current or future location or existence of any facilities, services or destinations. The plan is based on the present intention of, and information available to, Legacy Property and the current known requirements of relevant authorities at the time of creation of the plan and details may change due to future circumstances. Any indications of distance or size are approximate and for indicative purposes only and are not to scale. The plan and any matters shown on or inferred from it do not give rise to a legally binding obligation on or representation or warranty by Legacy Property. Legacy Property accepts no liability for any loss or damage arising as a result of any reliance on this plan or its contents.



# THE RANGES

GLEDSDOOD HILLS

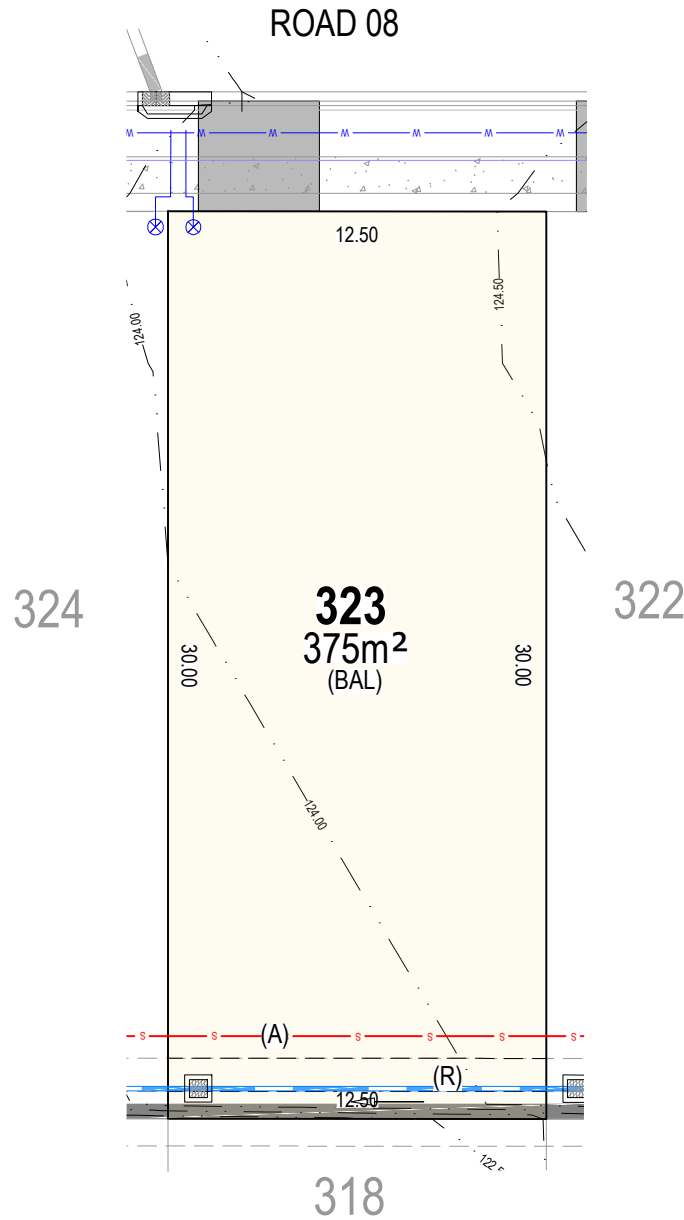

## LEGEND

|     |                              |       |   |
|-----|------------------------------|-------|---|
| 101 | PROPOSED CONTOUR             | (A)   | EASEMENT FOR DRAINAGE (2.00m WIDE)                          |
|     | PROPOSED RETAINING WALL      | (R)   | RETAINING WALL RESTRICTION & POSITIVE COVENANT (0.90m WIDE) |
|     | PROPOSED WATER               | (BAL) | BUSHFIRE ATTACK LEVEL - 12.5                                |
|     | PROPOSED SEWER               |       |   |
|     | PROPOSED STORMWATER AND PITS |       |   |
|     | PROPOSED EASEMENTS           |       |   |



• AREA SUBJECT TO FINAL SURVEY  
• BEARING AND DISTANCES SUBJECT TO FINAL SURVEY

0 5 10 A4  
1:250

NOTE:  
ALL CONTOURS HAVE INTERVAL OF 0.5m (CONTOURS ARE APPROXIMATE ONLY)

This plan is provided solely for the purpose of providing an impression of the concept relating to the proposed development called 'The Ranges', as well as the approximate location of existing and proposed third party facilities, services or destinations, and is not intended to be used for any other purpose. Legacy Property does not make any representation or give any warranty in relation to the future development of the site, the staging of any future development or the current or future location or existence of any facilities, services or destinations. The plan is based on the present intention of, and information available to, Legacy Property and the current known requirements of relevant authorities at the time of creation of the plan and details may change due to future circumstances. Any indications of distance or size are approximate and for indicative purposes only and are not to scale. The plan and any matters shown on or inferred from it do not give rise to a legally binding obligation on or representation or warranty by Legacy Property. Legacy Property accepts no liability for any loss or damage arising as a result of any reliance on this plan or its contents.



# THE RANGES

GLEDSDOOD HILLS

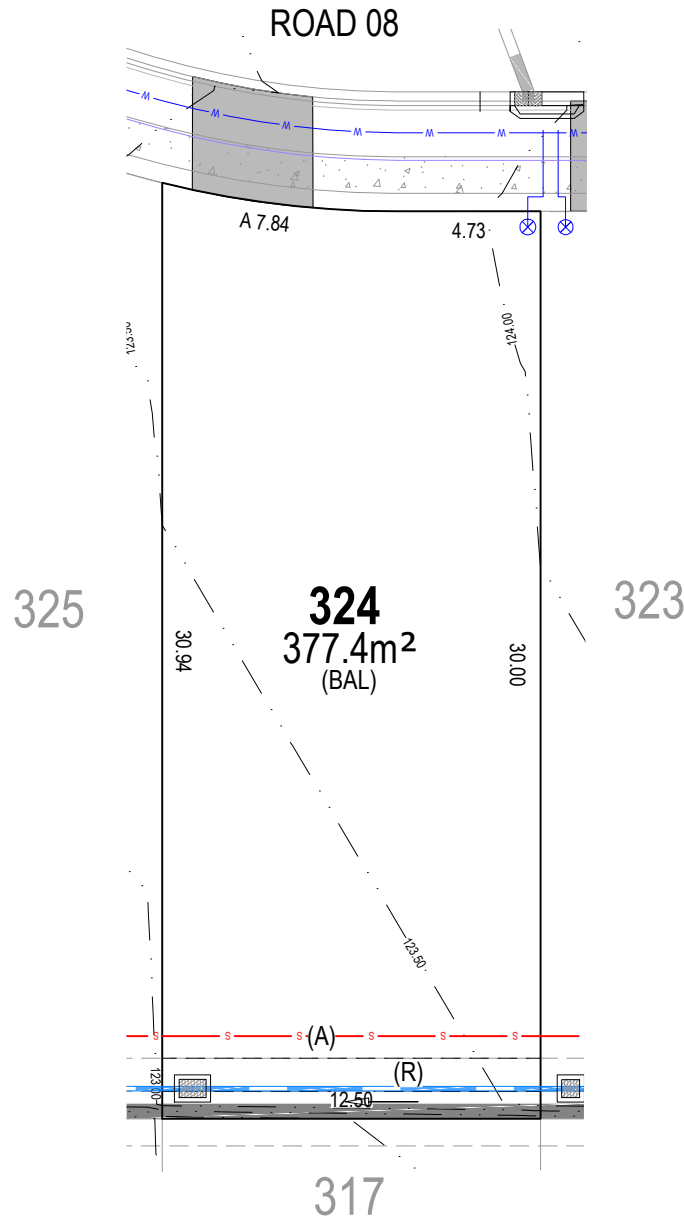

## LEGEND

|     |                              |       |   |
|-----|------------------------------|-------|---|
| 101 | PROPOSED CONTOUR             | (A)   | EASEMENT FOR DRAINAGE (2.00m WIDE)                          |
|     | PROPOSED RETAINING WALL      | (R)   | RETAINING WALL RESTRICTION & POSITIVE COVENANT (0.90m WIDE) |
|     | PROPOSED WATER               | (BAL) | BUSHFIRE ATTACK LEVEL - 12.5                                |
|     | PROPOSED SEWER               |       |   |
|     | PROPOSED STORMWATER AND PITS |       |   |
|     | PROPOSED EASEMENTS           |       |   |



• AREA SUBJECT TO FINAL SURVEY  
 • BEARING AND DISTANCES SUBJECT TO FINAL SURVEY

0 5 10 A4  
 1:250

NOTE:  
 ALL CONTOURS HAVE INTERVAL OF 0.5m (CONTOURS ARE APPROXIMATE ONLY)

This plan is provided solely for the purpose of providing an impression of the concept relating to the proposed development called 'The Ranges', as well as the approximate location of existing and proposed third party facilities, services or destinations, and is not intended to be used for any other purpose. Legacy Property does not make any representation or give any warranty in relation to the future development of the site, the staging of any future development or the current or future location or existence of any facilities, services or destinations. The plan is based on the present intention of, and information available to, Legacy Property and the current known requirements of relevant authorities at the time of creation of the plan and details may change due to future circumstances. Any indications of distance or size are approximate and for indicative purposes only and are not to scale. The plan and any matters shown on or inferred from it do not give rise to a legally binding obligation on or representation or warranty by Legacy Property. Legacy Property accepts no liability for any loss or damage arising as a result of any reliance on this plan or its contents.



# THE RANGES

GLEDSDOOD HILLS

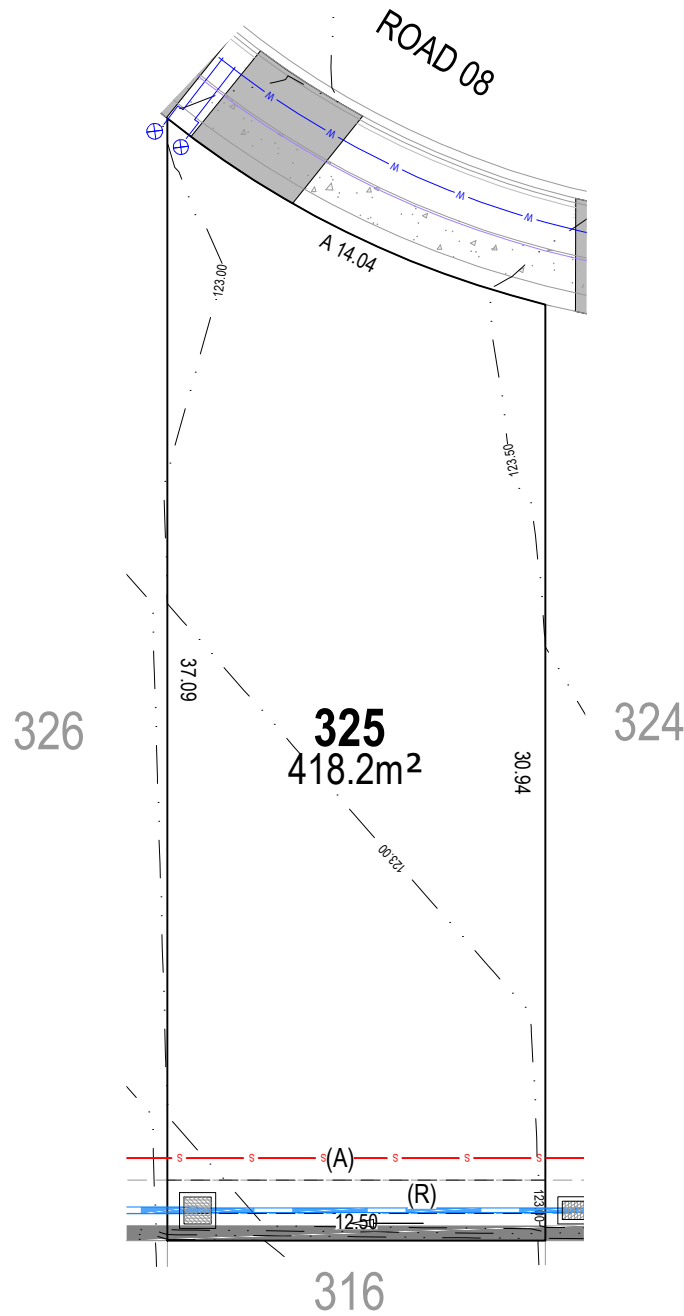

## LEGEND

|     |                              |     |   |
|-----|------------------------------|-----|---|
| 101 | PROPOSED CONTOUR             | (A) | EASEMENT FOR DRAINAGE (2.00m WIDE)                          |
|     | PROPOSED RETAINING WALL      | (R) | RETAINING WALL RESTRICTION & POSITIVE COVENANT (0.90m WIDE) |
|     | PROPOSED WATER               |     |   |
|     | PROPOSED SEWER               |     |   |
|     | PROPOSED STORMWATER AND PITS |     |   |
|     | PROPOSED EASEMENTS           |     |   |



• AREA SUBJECT TO FINAL SURVEY  
 • BEARING AND DISTANCES SUBJECT TO FINAL SURVEY

0 5 10 A4  
 1:250

NOTE:  
 ALL CONTOURS HAVE INTERVAL OF 0.5m (CONTOURS ARE APPROXIMATE ONLY)

This plan is provided solely for the purpose of providing an impression of the concept relating to the proposed development called 'The Ranges', as well as the approximate location of existing and proposed third party facilities, services or destinations, and is not intended to be used for any other purpose. Legacy Property does not make any representation or give any warranty in relation to the future development of the site, the staging of any future development or the current or future location or existence of any facilities, services or destinations. The plan is based on the present intention of, and information available to, Legacy Property and the current known requirements of relevant authorities at the time of creation of the plan and details may change due to future circumstances. Any indications of distance or size are approximate and for indicative purposes only and are not to scale. The plan and any matters shown on or inferred from it do not give rise to a legally binding obligation on or representation or warranty by Legacy Property. Legacy Property accepts no liability for any loss or damage arising as a result of any reliance on this plan or its contents.



# THE RANGES

GLEDSDOOD HILLS

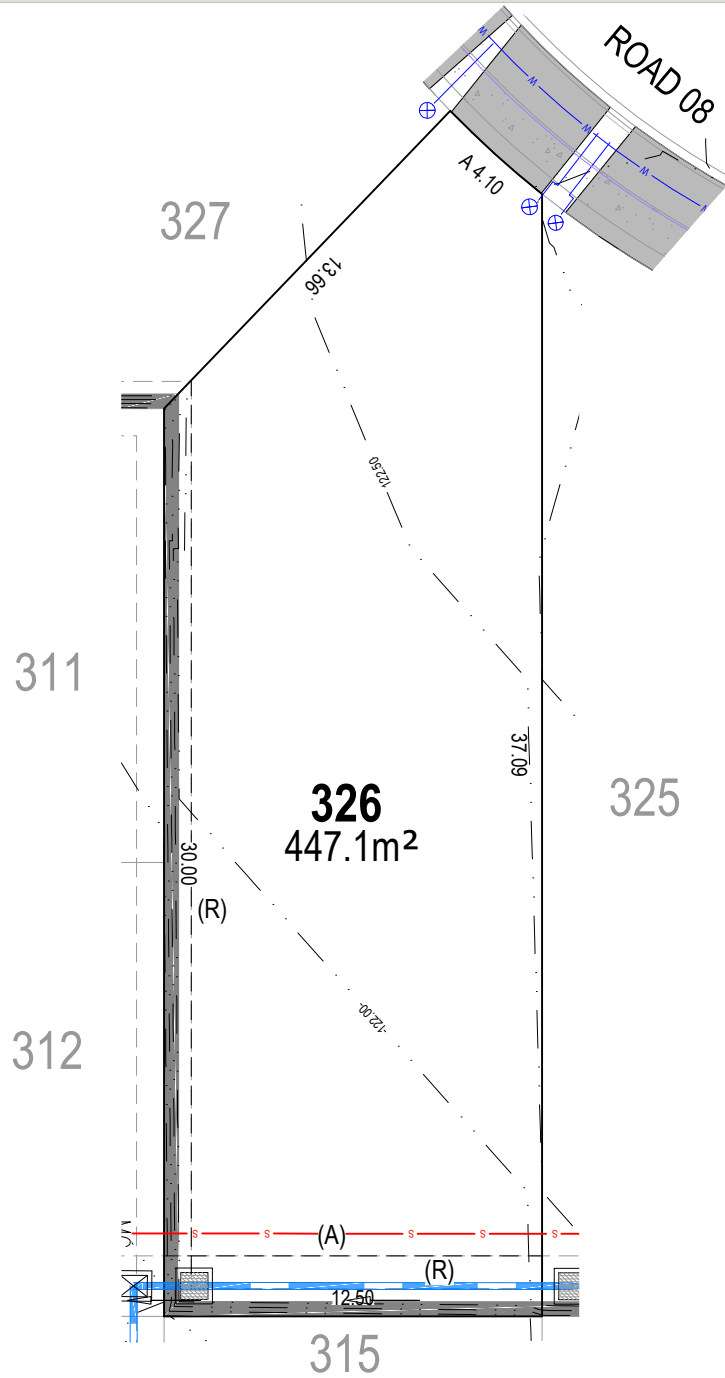

## LEGEND

- |     |                              |     |   |
|-----|------------------------------|-----|---|
| 101 | PROPOSED CONTOUR             | (A) | EASEMENT FOR DRAINAGE (2.00m WIDE)                          |
|     | PROPOSED RETAINING WALL      | (R) | RETAINING WALL RESTRICTION & POSITIVE COVENANT (0.90m WIDE) |
|     | PROPOSED WATER               |     |   |
|     | PROPOSED SEWER               |     |   |
|     | PROPOSED STORMWATER AND PITS |     |   |
|     | PROPOSED EASEMENTS           |     |   |



\* AREA SUBJECT TO FINAL SURVEY  
 \* BEARING AND DISTANCES SUBJECT TO FINAL SURVEY  
 0 5 10 A4  
 1:250

NOTE: ALL CONTOURS HAVE INTERVAL OF 0.5m (CONTOURS ARE APPROXIMATE ONLY)

This plan is provided solely for the purpose of providing an impression of the concept relating to the proposed development called 'The Ranges', as well as the approximate location of existing and proposed third party facilities, services or destinations, and is not intended to be used for any other purpose. Legacy Property does not make any representation or give any warranty in relation to the future development of the site, the staging of any future development or the current or future location or existence of any facilities, services or destinations. The plan is based on the present intention of, and information available to, Legacy Property and the current known requirements of relevant authorities at the time of creation of the plan and details may change due to future circumstances. Any indications of distance or size are approximate and for indicative purposes only and are not to scale. The plan and any matters shown on or inferred from it do not give rise to a legally binding obligation on or representation or warranty by Legacy Property. Legacy Property accepts no liability for any loss or damage arising as a result of any reliance on this plan or its contents.



